

1990 COUNTY BLOCK MAP (RECREATED): IMPERIAL County

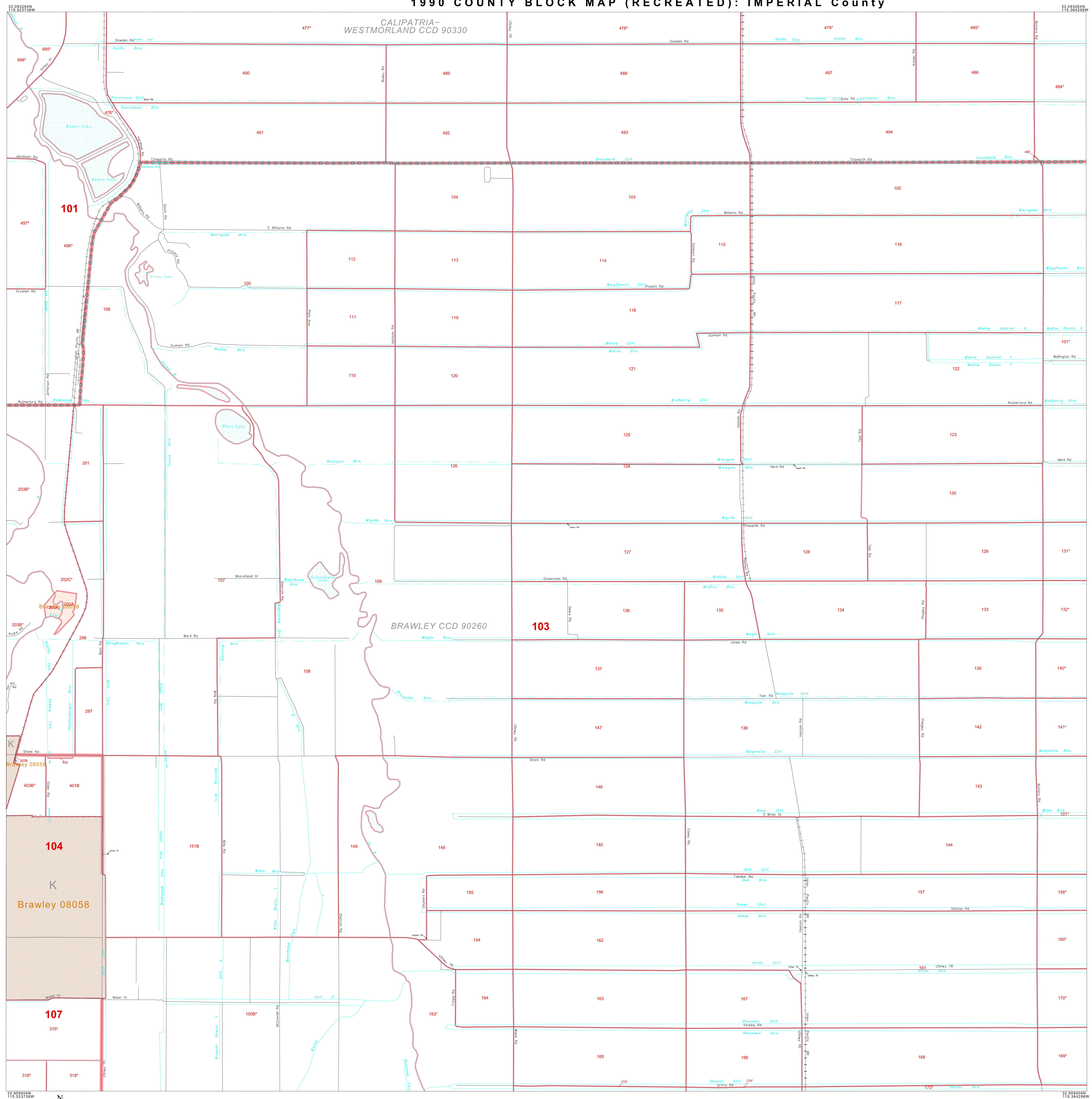

LEGEND

SYMBOL NAME STYLE

- INTERNATIONAL
- AIR
- Trust Land
- TJSA / TDSA / ANVSA
- ANRC
- MINOR CIVIL DIV' / CCD
- Place within Subject Entity
- Incorporated Place / CDP¹
- Place outside of Subject Entity
- Incorporated Place / CDP¹
- Census Tract / BNA²
- BLOCK³

ABBREVIATION REFERENCE: AIR = American Indian Reservation; Trust Land = Off-Reservation Trust Land; TDSA = Tribal Jurisdiction Statistical Area; TJSAs = Tribal Designated Statistical Area; ANVSA = Alaska Native Village Statistical Area; ANRC = Alaska Native Regional Corporation; CCD = Census Civil Division; CDP = Census Designated Place; BNA = Block Numbering Area

FEATURES

- Highway
- Secondary Road
- Prop/Place Line
- Ridge/Physical Feature
- Stream/Shoreline
- Intermittent Stream
- Prop/Place Line
- Property/Enclosure Line
- Nonvisible Boundary
- Railroad
- Canal
- Well
- Water Tower
- Water Tank
- Water Pump
- Water Valve
- Water Meter
- Water Main
- Water Lateral
- Water Drain
- Water Pipe
- Water Sewer
- Water Tunnel
- Water Conduit
- Water Pipe
- Water Sewer
- Water Tunnel
- Water Conduit

Inset **Out Area**

Where international, state, and/or county boundaries coincide, the map shows the boundary symbol for only the highest-ranking of these boundaries.
¹ A "*" following a place name indicates that the place is also a false MCD; the false MCD name is not shown.
² In 1990, the crew-of-vessel population of ships at sea was allocated to census tracts with a "SP" suffix. An anchor symbol appeared on the 1990 maps locating a crew-of-vessel tract. These maps show a very small area symbolized as a census tract with the census tract number shown near the area.
³ A "*" following a block number indicates that the block number is repeated elsewhere in the block.