

1990 COUNTY BLOCK MAP (RECREATED): RIVERSIDE County

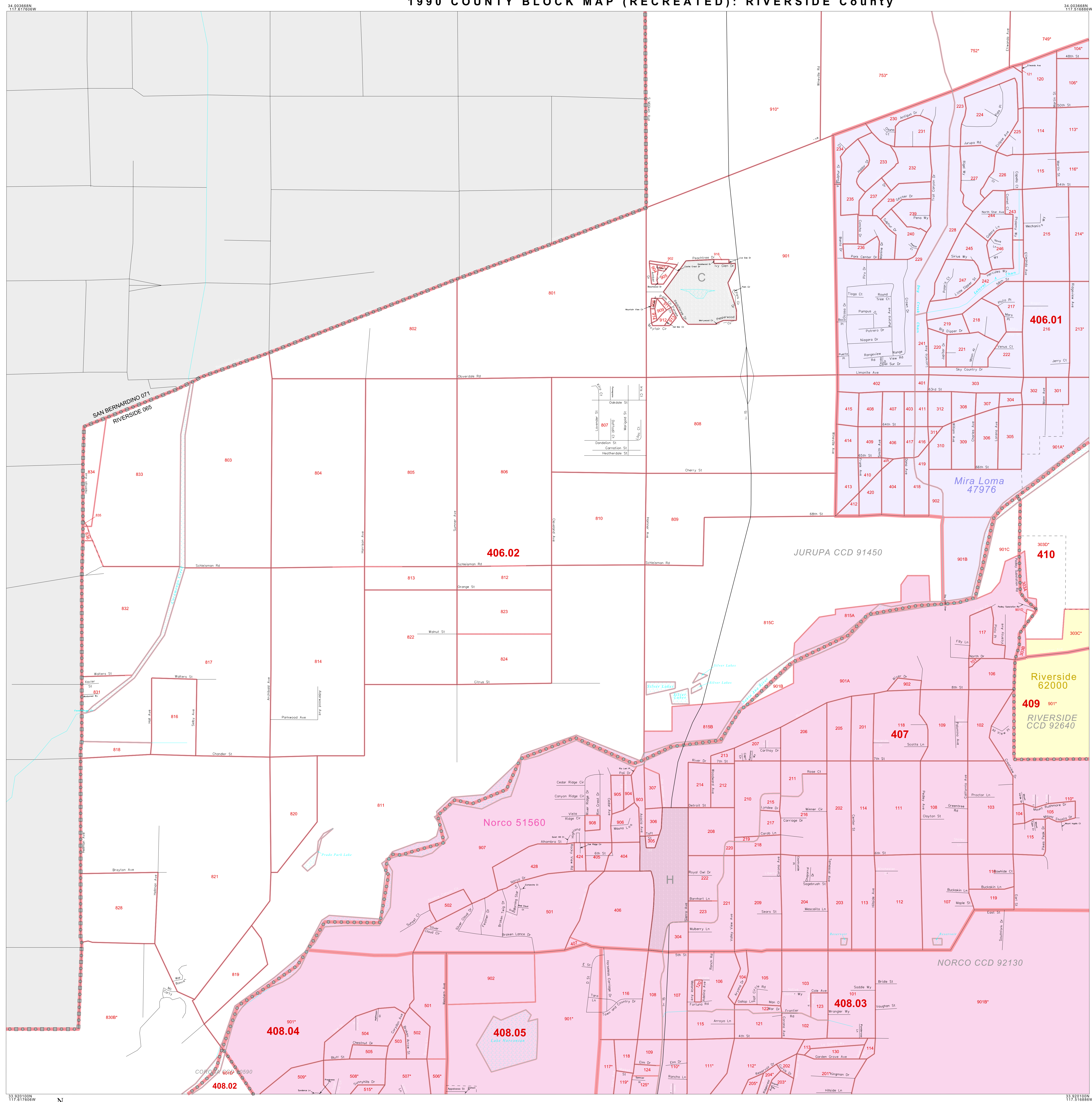

LEGEND

SYMBOL NAME STYLE

- INTERNATIONAL
- AIR
- Trust Land
- TJSA / TDSA / ANVSA
- ANRC
- MINOR CIVIL DIV. / CCD
- Place within Subject Entity
- Incorporated Place / CDP¹
- Place outside of Subject Entity
- Incorporated Place / CDP¹
- Census Tract / BNA²
- BLOCK³

ABBREVIATION REFERENCE: AIR = American Indian Reservation; Trust Land = Off-Reservation Trust Land; TDSA = Tribal Jurisdiction Statistical Area; TJSA = Tribal Designated Statistical Area; ANVSA = Alaska Native Village Statistical Area; ANRC = Alaska Native Regional Corporation; CCD = Census Civil Division; CDP = Census Designated Place; BNA = Block Numbering Area

FEATURES

- Highway
- Secondary Road
- Deep Trench/Wharf/Ferry
- Railroad
- Ridge/Place Line
- Ridge/Physical Feature
- Property/Fence Line
- Nonvisible Boundary
- Stream/Shoreline
- Intermittent Stream
- River
- Glacier

Where international, state, and/or county boundaries coincide, the map shows the boundary symbol for only the highest-ranking of these boundaries.

¹ A "*" following a place name indicates that the place is also a false MCD; the false MCD name is not shown.

² In 1990, the crew-of-vessel population of ships at sea was allocated to census tracts with a "99" suffix. An anchor symbol appeared on the 1990 maps locating a crew-of-vessel tract. These maps show a very small area symbolized as a census tract with the census tract number shown near the area.

³ A "*" following a block number indicates that the block number is repeated elsewhere in the block.

Inset Out Area

Key to Adjacent Sheets

1	2
33	34
35	66
67	68

Sheet Location within Entity

SHEET 34 OF 250 PARENT SHEETS
TOTAL SHEETS: 310 (Index 1; Parent 250; Inset 59)