

1990 COUNTY BLOCK MAP (RECREATED): SAN JOAQUIN County

37.98966N
120.999113W

37.98966N
120.914193W

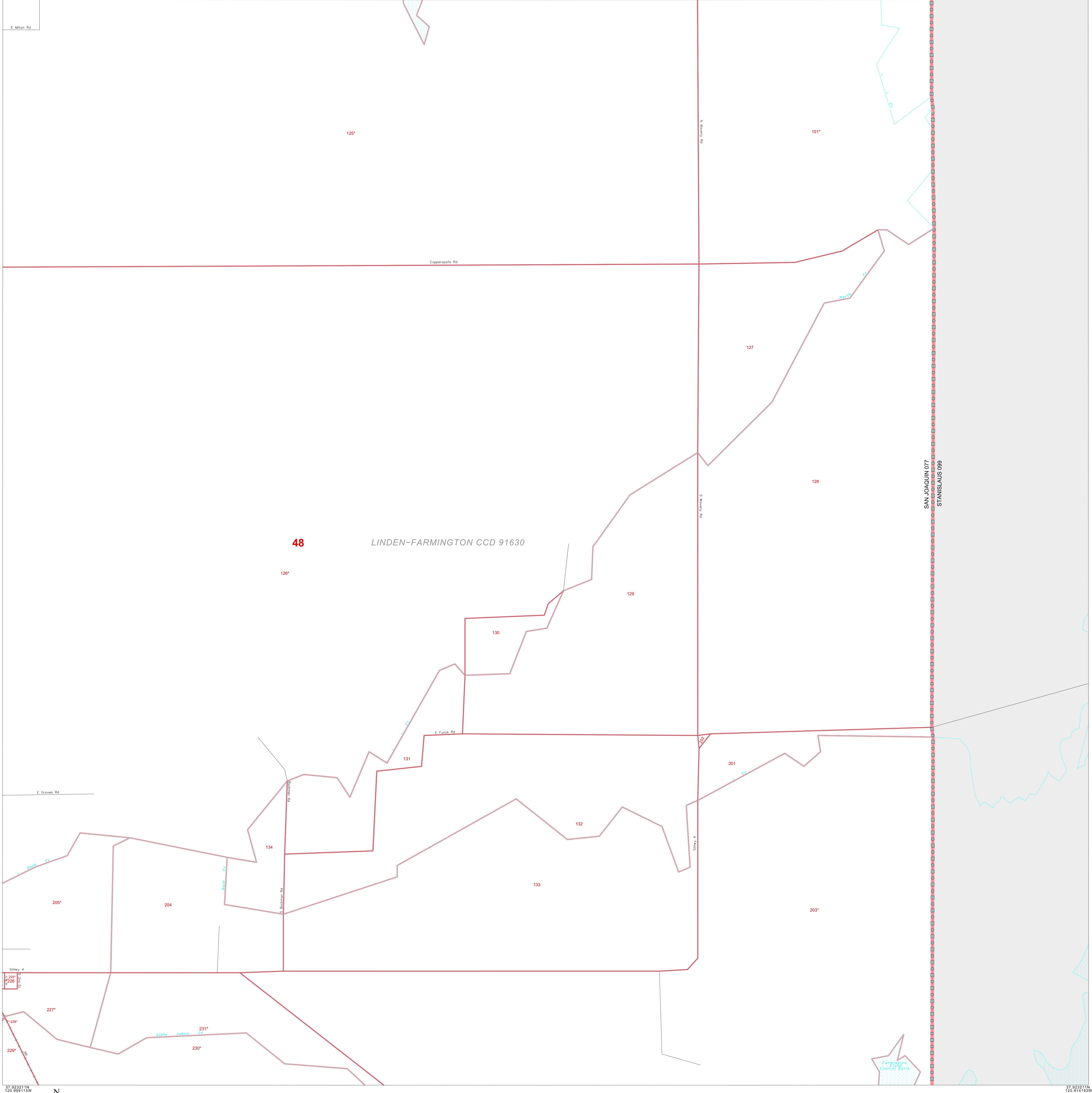

LEGEND

SYMBOL	NAME STYLE
*****	INTERNATIONAL
*****	AIR
*****	Trust Land
*****	TJSA / TDSA / ANVSA
*****	ANRC
*****	MINOR CIVIL DIV' / CCD
*****	Place within Subject Entity
*****	Incorporated Place / CDP ¹
*****	Place outside of Subject Entity
*****	Incorporated Place / CDP ¹
*****	Census Tract / BNA ²
*****	BLOCK ³

ABBREVIATION REFERENCE: AIR = American Indian Reservation; Trust Land = Off-Reservation Trust Land; TDSA = Tribal Jurisdiction Statistical Area; TJSA = Tribal Designated Statistical Area; ANVSA = Alaska Native Village Statistical Area; ANRC = Alaska Native Regional Corporation; CCD = Census Civil Division; CDP = Census Designated Place; BNA = Block Numbering Area

FEATURES

Highway	Pipe/Paver Line	Stream/Shoreline
Secondary Road	Ridge/Physical Feature	Intermittent Stream
Deep Trench/Wetway/Ferry	Property/Fence Line	River
Railroad	Nonvisible Boundary	Canal

Where international, state, and/or county boundaries coincide, the map shows the boundary symbol for only the highest-ranking of these boundaries.

¹ A "*" following a place name indicates that the place is also a false MCD; the false MCD name is not shown.

² In 1990, the census-of-vessel population of ships at sea was allocated to census tracts with a "SP" suffix. An anchor symbol appeared on the 1990 maps locating a census-of-vessel tract. These maps show a very small area symbolized as a census tract with the census tract number shown near the area.

³ A "*" following a block number indicates that the block number is repeated elsewhere in the block.

37.923211N
120.999113W

37.923211N
120.914193W

37.923211N
120.999113W

37.923211N
120.999113W

37.923211N
120.999113W

37.923211N
120.999113W

37.923211N
120.999113W

37.923211N
120.999113W

37.923211N
120.999113W

37.923211N
120.999113W

37.923211N
120.999113W

37.923211N
120.999113W

37.923211N
120.999113W

37.923211N
120.999113W

37.923211N
120.999113W

37.923211N
120.999113W

37.923211N
120.999113W

37.923211N
120.999113W

37.923211N
120.999113W

37.923211N
120.999113W

37.923211N
120.999113W

37.923211N
120.999113W

37.923211N
120.999113W

37.923211N
120.999113W

37.923211N
120.999113W

37.923211N
120.999113W

37.923211N
120.999113W

37.923211N
120.999113W

37.923211N
120.999113W

37.923211N
120.999113W

37.923211N
120.999113W

37.923211N
120.999113W

37.923211N
120.999113W

37.923211N
120.999113W

37.923211N
120.999113W

37.923211N
120.999113W

37.923211N
120.999113W

37.923211N
120.999113W

37.923211N
120.999113W

37.923211N
120.999113W

37.923211N
120.999113W

37.923211N
120.999113W

37.923211N
120.999113W

37.923211N
120.999113W

37.923211N
120.999113W

37.923211N
120.999113W

37.923211N
120.999113W

37.923211N
120.999113W

37.923211N
120.999113W

37.923211N
120.999113W

37.923211N
120.999113W

37.923211N
120.999113W

37.923211N
120.999113W

37.923211N
120.999113W

37.923211N
120.999113W

37.923211N
120.999113W

37.923211N
120.999113W

37.923211N
120.999113W

37.923211N
120.999113W

37.923211N
120.999113W

37.923211N
120.999113W

37.923211N
120.999113W

37.923211N
120.999113W

37.923211N
120.999113W

37.923211N
120.999113W

37.923211N
120.999113W

37.923211N
120.999113W

37.923211N
120.999113W

37.923211N
120.999113W

37.923211N
120.999113W

37.923211N
120.999113W

37.923211N
120.999113W

37.923211N
120.999113W

37.923211N
120.999113W

37.923211N
120.999113W

37.923211N
120.999113W

37.923211N
120.999113W

37.923211N
120.999113W

37.923211N
120.999113W

37.923211N
120.999113W

37.923211N
120.999113W

37.923211N
120.999113W

37.923211N
120.999113W

37.923211N
120.999113W

37.923211N
120.999113W

37.923211N
120.999113W

37.923211N
120.999113W

37.923211N
120.999113W

37.923211N
120.999113W

37.923211N
120.999113W

37.923211N
120.999113W

37.923211N
120.999113W

37.923211N
120.999113W

37.923211N
120.999113W

37.923211N
120.999113W

37.923211N
120.999113W

37.923211N
120.999113W

37.923211N
120.999113W

37.923211N
120.999113W

37.923211N
120.999113W

37.923211N
120.999113W

37.923211N
120.999113W

37.923211N
120.999113W

37.923211N
120.999113W

37.923211N
120.999113W

37.923211N
120.999113W

37.923211N
120.999113W

37.923211N
120.999113W

37.923211N
120.999113W

37.923211N
120.999113W

37.923211N
120.999113W

37.923211N
120.999113W

37.923211N
120.999113W

37.923211N
120.999113W

37.923211N
120.999113W

37.923211N
120.999113W

37.923211N
120.999113W

37.923211N
120.999113W

37.923211N
120.999113W

37.923211N
120.999113W

37.923211N
120.999113W

37.923211N
120.999113W

37.923211N
120.999113W

37.923211N
120.999113W

37.923211N
120.999113W

37.923211N
120.999113W

37.923211N
120.999113W

37.923211N
120.999113W

37.923211N
120.999113W

37.923211N
120.999113W

37.923211N
120.999113W

37.923211N
120.999113W

37.923211N
120.999113W

37.923211N
120.999113W

37.923211N
120.999113W

37.923211N
120.999113W

37.923211N
120.999113W

37.923211N
120.999113W

37.923211N
120.999113W

37.923211N
120.999113W

37.923211N
120.999113W

37.923211N
120.999113W

37.923211N
120.999113W

37.923211N
120.999113W

37.923211N
120.999113W

37.923211N
120.999113W

37.923211N
120.999113W

37.923211N
120.999113W

37.923211N
120.999113W

37.923211N
120.999113W

37.923211N
120.999113W

37.923211N
120.999113W

37.923211N
120.999113W

37.923211N
120.999113W

37.923211N
120.999113W

37.923211N
120.999113W

37.923211N
120.999113W

37.923211N
120.999113W

37.923211N
120.999113W

37.923211N
120.999113W

37.923211N
120.999113W

37.923211N
120.999113W

37.923211N
120.999113W

37.923211N
120.999113W

37.923211N
120.999113W

37.923211N
120.999113W

37.923211N
120.999113W

37.923211N
120.999113W

37.923211N
120.999113W

37.923211N
120.999113W

37.923211N
120.999113W

37.923211N
120.999113W

37.923211N
120.999113W

37.923211N
120.999113W

37.923211N
120.999113W

37.923211N
120.999113W

37.923211N
120.999113W

37.923211N
120.999113W

37.923211N
120.999113W

37.923211N
120.999113W

37.923211N
120.999113W

37.923211N
120.999113W