

1990 COUNTY BLOCK MAP (RECREATED): LOGAN County

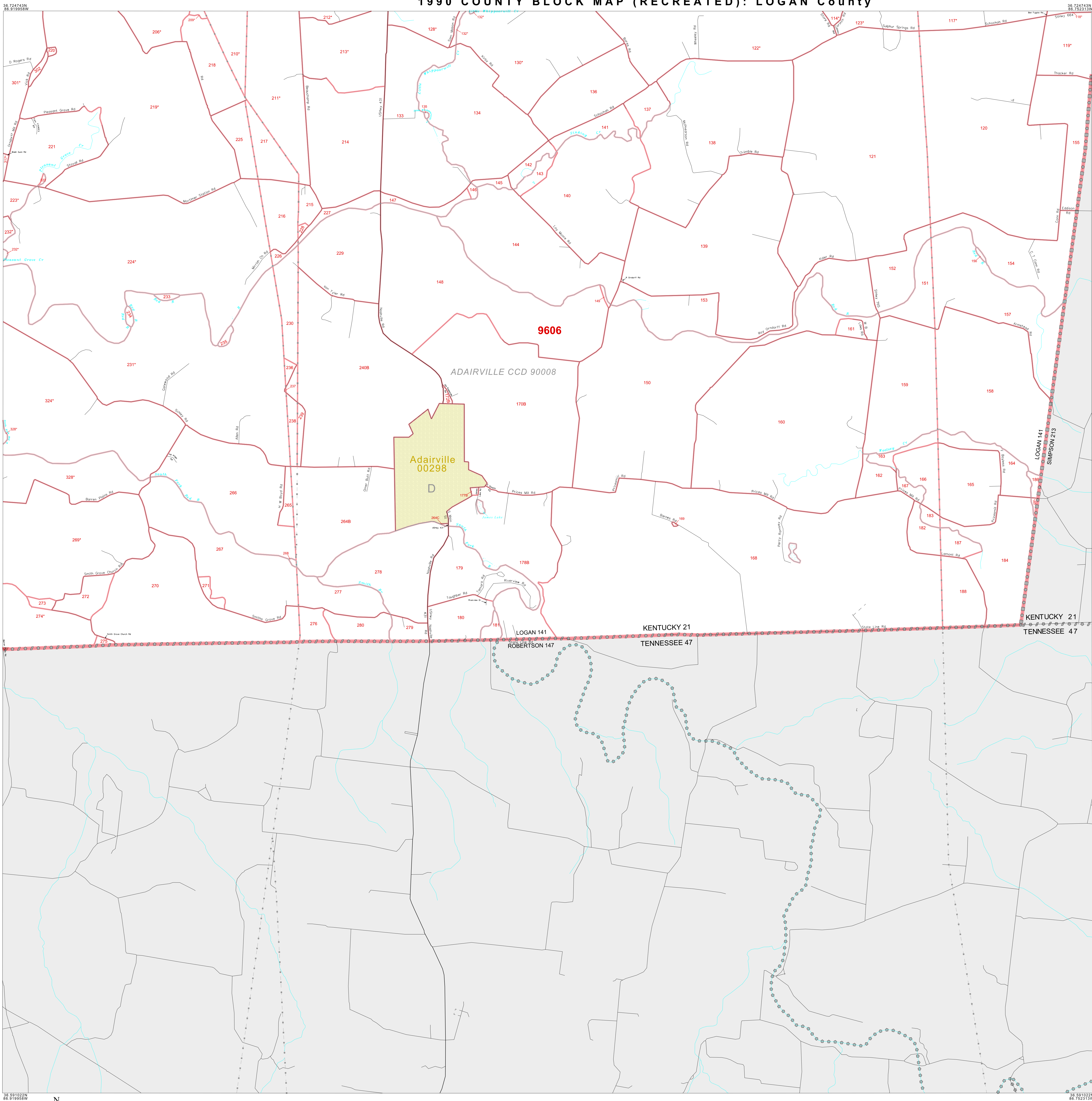

LEGEND

SYMBOL **NAME STYLE**

☆☆☆☆☆ **INTERNATIONAL**

☆☆☆☆☆ **AIR**

☆☆☆☆☆ **Trust Land**

☆☆☆☆☆ **TJSA / TDSA / ANVSA**

☆☆☆☆☆ **ANRC**

■■■■■■■ **MINOR CIVIL DIV. / CCD**

■■■■■■■ **Place within Subject Entity**

■■■■■■■ **Incorporated Place / CDP¹**

■■■■■■■ **Place outside of Subject Entity**

■■■■■■■ **Incorporated Place / CDP¹**

■■■■■■■ **Census Tract / BNA²**

■■■■■■■ **BLOCK³**

ABBREVIATION REFERENCE: AIR = American Indian Reservation; Trust Land = Off-Reservation Trust Land; TDSA = Tribal Jurisdiction Statistical Area; TJSA = Tribal Designated Statistical Area; ANVSA = Alaska Native Village Statistical Area; ANRC = Alaska Native Regional Corporation; CCD = Census Civil Division; CDP = Census Designated Place; BNA = Block Numbering Area

FEATURES

Highway	Pipe/Pipe Line	Stream/Shoaline
Secondary Road	Ridge/Physical Feature	Intermittent Stream
Deep Trail/Wharf/Ferry	Property/Fence Line	River
Railroad	Nonvisible Boundary	Glacier

Where international, state, and/or county boundaries coincide, the map shows the boundary symbol for only the highest-ranking of these boundaries.

¹ A "*" following a place name indicates that the place is also a false MCD; the false MCD name is not shown.

² In 1990, the census-of-vessels population of ships at sea was allocated to census tracts with a "SP" suffix. An anchor symbol appeared on the 1990 maps locating a census-of-vessels tract. These maps show a very small area symbolized as a census tract with the census tract number shown near the area.

³ A "*" following a block number indicates that the block number is repeated elsewhere in the block.

Inset **Out Area**

Key to Adjacent Sheets

7	8	9
10	11	12

SHEET LOCATION WITHIN ENTITY

SHEET 11 OF 12 PARENT SHEETS
TOTAL SHEETS: 18 (Index 1; Parent 12; Inset 5)