

1990 COUNTY BLOCK MAP (RECREATED): ALLEGAN County

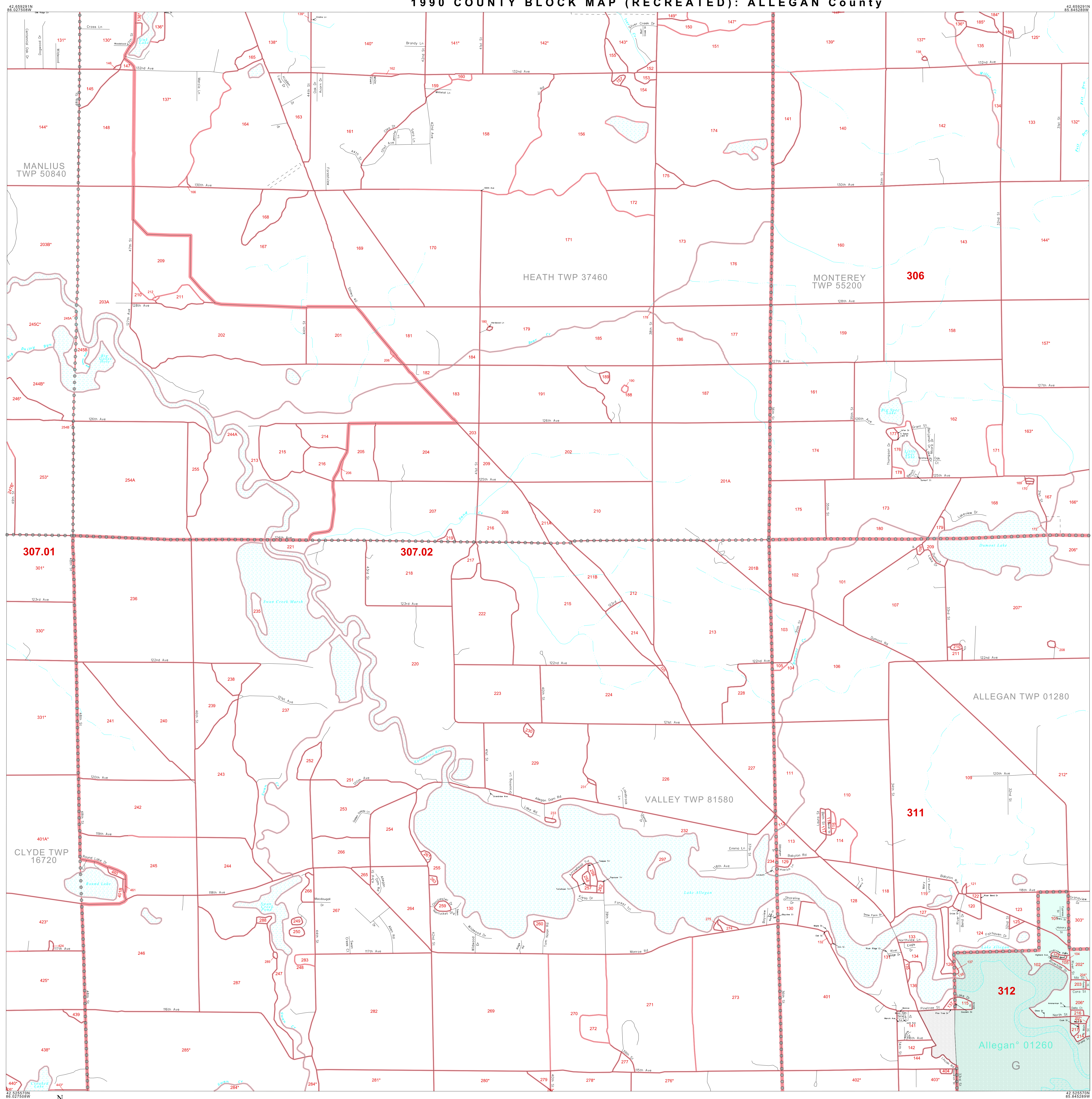

LEGEND

SYMBOL **NAME STYLE**

***** **INTERNATIONAL**

***** **AIR**

***** **Trust Land**

***** **TJSA / TDSA / ANVSA**

***** **ANRC**

----- **MINOR CIVIL DIV. / CCD**

----- **Place within Subject Entity**

----- **Incorporated Place / CDP¹**

----- **Place outside of Subject Entity**

----- **Incorporated Place / CDP¹**

----- **Census Tract / BNA²**

----- **BLOCK³**

ABBREVIATION REFERENCE: AIR = American Indian Reservation; Trust Land = Off-Reservation Trust Land; TDSA = Tribal Jurisdiction Statistical Area; TJSA = Tribal Designated Statistical Area; ANVSA = Alaska Native Village Statistical Area; ANRC = Alaska Native Regional Corporation; CCD = Census Civil Division; CDP = Census Designated Place; BNA = Block Numbering Area

FEATURES

Highway	Pipe/Paver Line	Stream/Shoaling
Secondary Road	Ridge/Physical Feature	Intermittent Stream
Deep Trench/Warehouse/Ferry	Property/Fence Line	River
Rollroad	Nonvisible Boundary	Gravel

Where international, state, and/or county boundaries coincide, the map shows the boundary symbol for only the highest-ranking of these boundaries.

¹ A "*" following a place name indicates that the place is also a false MCD; the false MCD name is not shown.

² In 1990, the crew-of-vehicle population of ships at sea was allocated to census tracts with a "SP" suffix. An anchor symbol appeared on the 1990 maps locating a crew-of-vehicle tract. These maps show a very small area symbolized as a census tract with the census tract number shown near the area.

³ A "*" following a block number indicates that the block number is repeated elsewhere in the block.

Inset **Out Area**