

1990 COUNTY BLOCK MAP (RECREATED): GENESEE County

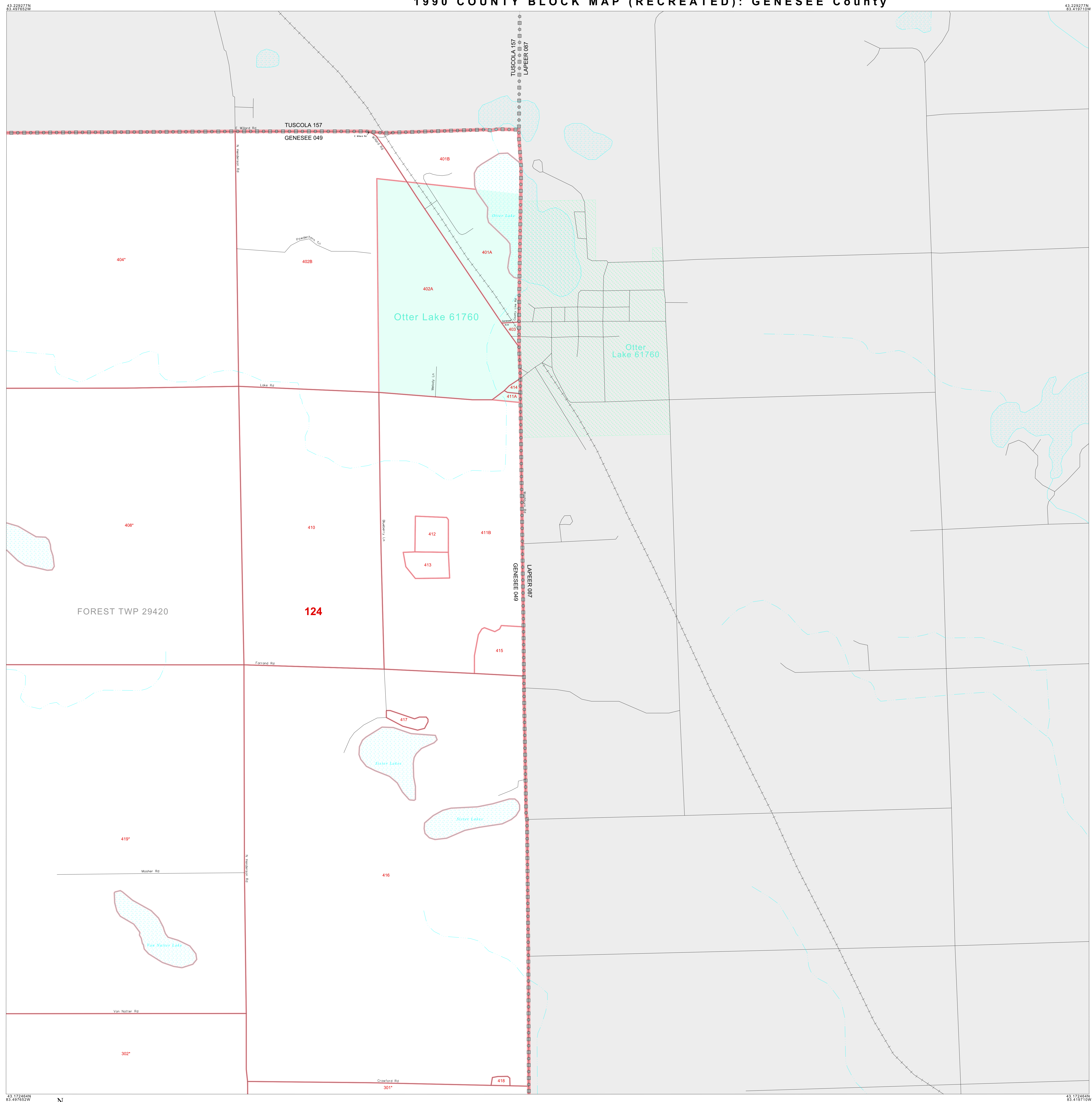

LEGEND

| SYMBOL | NAME STYLE |
|--------|---------------------------------------|
| ***** | INTERNATIONAL |
| ***** | AIR |
| ***** | Trust Land |
| ***** | TJSA / TDSA / ANVSA |
| ***** | ANRC |
| | MINOR CIVIL DIV ¹ / CCD |
| □ | Place within Subject Entity |
| □ | Incorporated Place / CDP ¹ |
| □ | Place outside of Subject Entity |
| □ | Incorporated Place / CDP ¹ |
| — | Census Tract / BNA ² |
| — | BLOCK ³ |

ABBREVIATION REFERENCE: AIR = American Indian Reservation; Trust Land = Off-Reservation Trust Land; TDSA = Tribal Jurisdiction Statistical Area; TJSA = Tribal Designated Statistical Area; ANVSA = Alaska Native Village Statistical Area; ANRC = Alaska Native Regional Corporation; CCD = Census Civil Division; CDP = Census Designated Place; BNA = Block Numbering Area

| FEATURES | |
|-------------------------|------------------------|
| Highway | Ridge/Physical Feature |
| Secondary Road | Stream/Shoreline |
| Deep Inlet/Wetway/Ferry | Intermittent Stream |
| Rollroad | River |
| | Property/Fence Line |
| | Nonvisible Boundary |
| | Creeks |

Where international, state, and/or county boundaries coincide, the map shows the boundary symbol for only the highest-ranking of these boundaries.
¹ A "*" following a place name indicates that the place is also a false MCD; the false MCD name is not shown.
² In 1990, the census-of-vessel population of ships at sea was allocated to census tracts with a "SP" suffix. An anchor symbol appeared on the 1990 maps locating a census-of-vessel tract. These maps show a very small area symbolized as a census tract with the census tract number shown near the area.
³ A "*" following a block number indicates that the block number is repeated elsewhere in the block.

43.229277N
83.497652W

The plotted map scale is 1:8500

43.229277N
83.419710W

ENTITY TYPE: County
 NAME: Genesee County (049)
 ST: Michigan (26)

1990 COUNTY BLOCK MAP (RECREATED)
 (PWRDLK) 19526049007000000000

Key to Adjacent Sheets

| | |
|----|----|
| 6 | 7 |
| 13 | 14 |

Sheet Location within Entity

SHEET 7 OF 53 PARENT SHEETS
 TOTAL SHEETS: 57 (Index 1; Parent 53; Inset 3)