

1990 COUNTY BLOCK MAP (RECREATED): LUCE County

**LEGEND**

SYMBOL	NAME STYLE
*****	INTERNATIONAL
*****	AIR
*****	Trust Land
*****	TJSA / TDSA / ANVSA
*****	ANRC
*****	MINOR CIVIL DIV <sup>1</sup> / CCD
*****	Place within Subject Entity
*****	Incorporated Place / CDP <sup>1</sup>
*****	Place outside of Subject Entity
*****	Incorporated Place / CDP <sup>1</sup>
*****	Census Tract / BNA <sup>2</sup>
*****	BLOCK <sup>3</sup>

**ABBREVIATION REFERENCE:** AIR = American Indian Reservation; Trust Land = Off-Reservation Trust Land; TDSA = Tribal Jurisdiction Statistical Area; TJSA = Tribal Designated Statistical Area; ANVSA = Alaska Native Village Statistical Area; ANRC = Alaska Native Regional Corporation; CCD = Census Civil Division; CDP = Census Designated Place; BNA = Block Numbering Area

**FEATURES**

Highway	Pipe/Paver Line	Stream/Shoreline
Secondary Road	Ridge/Physical Feature	Intermittent Stream
Deep Trench/Wharf/Ferry	Property/Fence Line	River
Rollroad	Nonvisible Boundary	Creeks

Where international, state, and/or county boundaries coincide, the map shows the boundary symbol for only the highest-ranking of these boundaries.

<sup>1</sup> A "\*" following a place name indicates that the place is also a false MCD; the false MCD name is not shown.

<sup>2</sup> In 1990, the census-of-vessel population of ships at sea was allocated to census tracts with a "SV" suffix. An anchor symbol appeared on the 1990 maps locating a census-of-vessel tract. These maps show a very small area symbolized as a census tract with the census tract number shown near the area.

<sup>3</sup> A "\*" following a block number indicates that the block number is repeated elsewhere in the block.

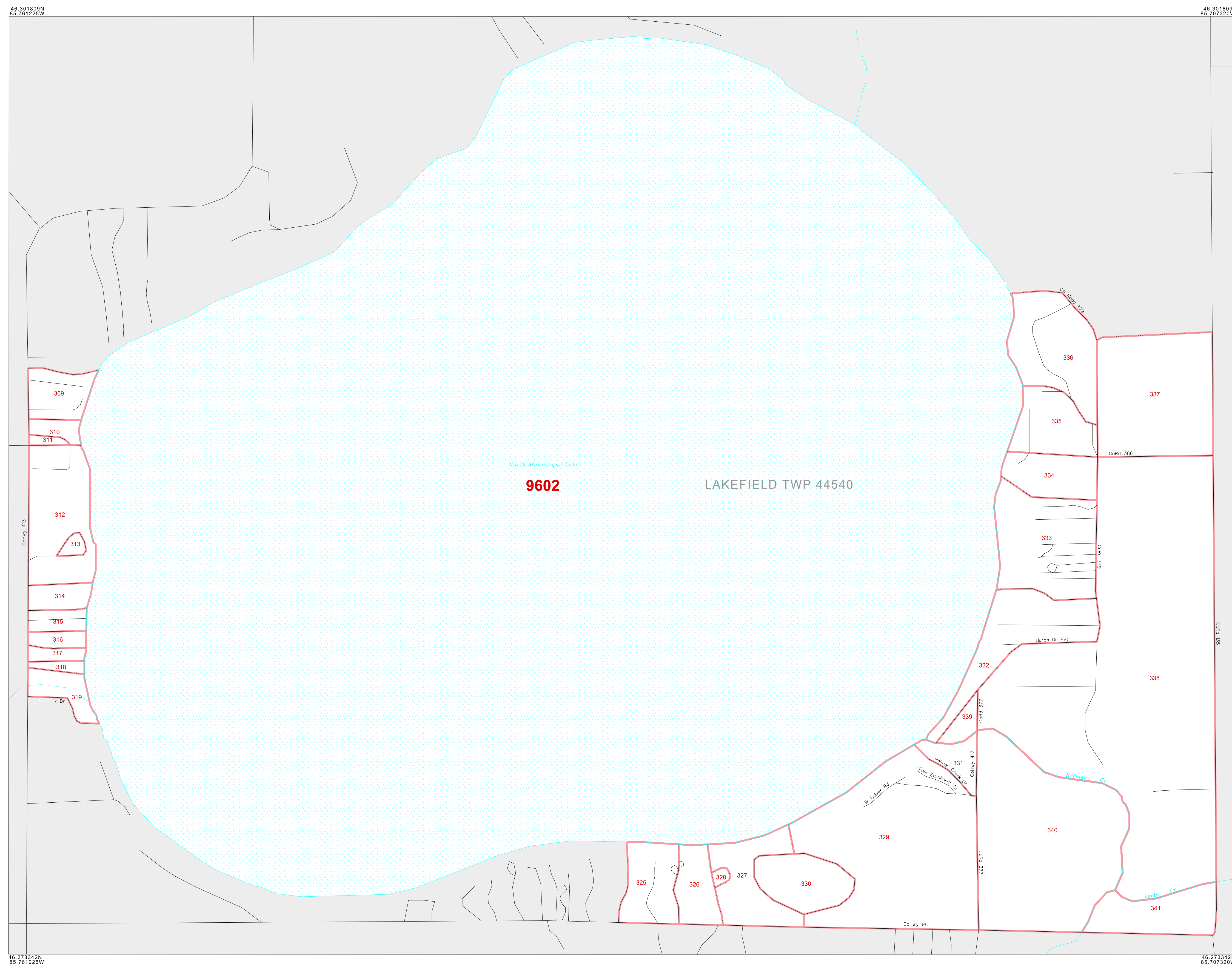

46 213342N 85 761225W

46 213342N 85 707320W

46 213342N 85 761225W

46 213342N 85 707320W

North Manitowish Lake

9602

LAKEFIELD TWP 44540

309 310 311 312 313 314 315 316 317 318 319 320 321 322 323 324 325 326 327 328 329 330 331 332 333 334 335 336 337 338 339 340 341

W. Colney Rd. Colney 98 Colney 377 Colney 386 Colney 387 Colney 388 Colney 389 Colney 390 Colney 391 Colney 392 Colney 393 Colney 394 Colney 395 Colney 396 Colney 397 Colney 398 Colney 399 Colney 400 Colney 401 Colney 402 Colney 403 Colney 404 Colney 405 Colney 406 Colney 407 Colney 408 Colney 409 Colney 410 Colney 411 Colney 412 Colney 413 Colney 414 Colney 415 Colney 416 Colney 417 Colney 418 Colney 419 Colney 420 Colney 421 Colney 422 Colney 423 Colney 424 Colney 425 Colney 426 Colney 427 Colney 428 Colney 429 Colney 430 Colney 431 Colney 432 Colney 433 Colney 434 Colney 435 Colney 436 Colney 437 Colney 438 Colney 439 Colney 440 Colney 441 Colney 442 Colney 443 Colney 444 Colney 445 Colney 446 Colney 447 Colney 448 Colney 449 Colney 450 Colney 451 Colney 452 Colney 453 Colney 454 Colney 455 Colney 456 Colney 457 Colney 458 Colney 459 Colney 460 Colney 461 Colney 462 Colney 463 Colney 464 Colney 465 Colney 466 Colney 467 Colney 468 Colney 469 Colney 470 Colney 471 Colney 472 Colney 473 Colney 474 Colney 475 Colney 476 Colney 477 Colney 478 Colney 479 Colney 480 Colney 481 Colney 482 Colney 483 Colney 484 Colney 485 Colney 486 Colney 487 Colney 488 Colney 489 Colney 490 Colney 491 Colney 492 Colney 493 Colney 494 Colney 495 Colney 496 Colney 497 Colney 498 Colney 499 Colney 500

Highway

Secondary Road

Deep Trench/Wharf/Ferry

Rollroad

Pipe/Paver Line

Ridge/Physical Feature

Property/Fence Line

Nonvisible Boundary

Stream/Shoreline

Intermittent Stream

River

Creeks

Inset

Out Area

Key to Adjacent Sheets

Sheet Location within Entity

INSET SHEET B01 of B01

TOTAL SHEETS: 7 (Index 1; Parent 4; Inset 2)

ENTITY TYPE: County

NAME: Luce County (095)

ST: Michigan (26)

1990 COUNTY BLOCK MAP (RECREATED)

(PWRDLK) 19526095660100000000

All legal boundaries and names are as of January 1, 1990 as tabulated for the Public Law 94-171 and Summary Tape File products. The boundaries also reflect the feature network and coordinates as of the Census 2000 geographic base. Since 1990 the Census Bureau updated the base from the North American Datum of 1927 (NAD27) to the datum as of 1983 (NAD83) and made numerous updates to the base features from those depicted in 1990. The boundaries shown on this map are for the Census Bureau's statistical data collection and tabulation purposes only; their depiction and designation for statistical purposes does not constitute a determination of jurisdictional authority or rights or ownership or entitlement. Source: U.S. Census Bureau's TIGER database (Census 2000) Projection: State-based Albers' Equal Area U.S. DEPARTMENT OF COMMERCE Economics and Statistics Administration U.S. Census Bureau