

# 1990 COUNTY BLOCK MAP (RECREATED): YELLOWSTONE County

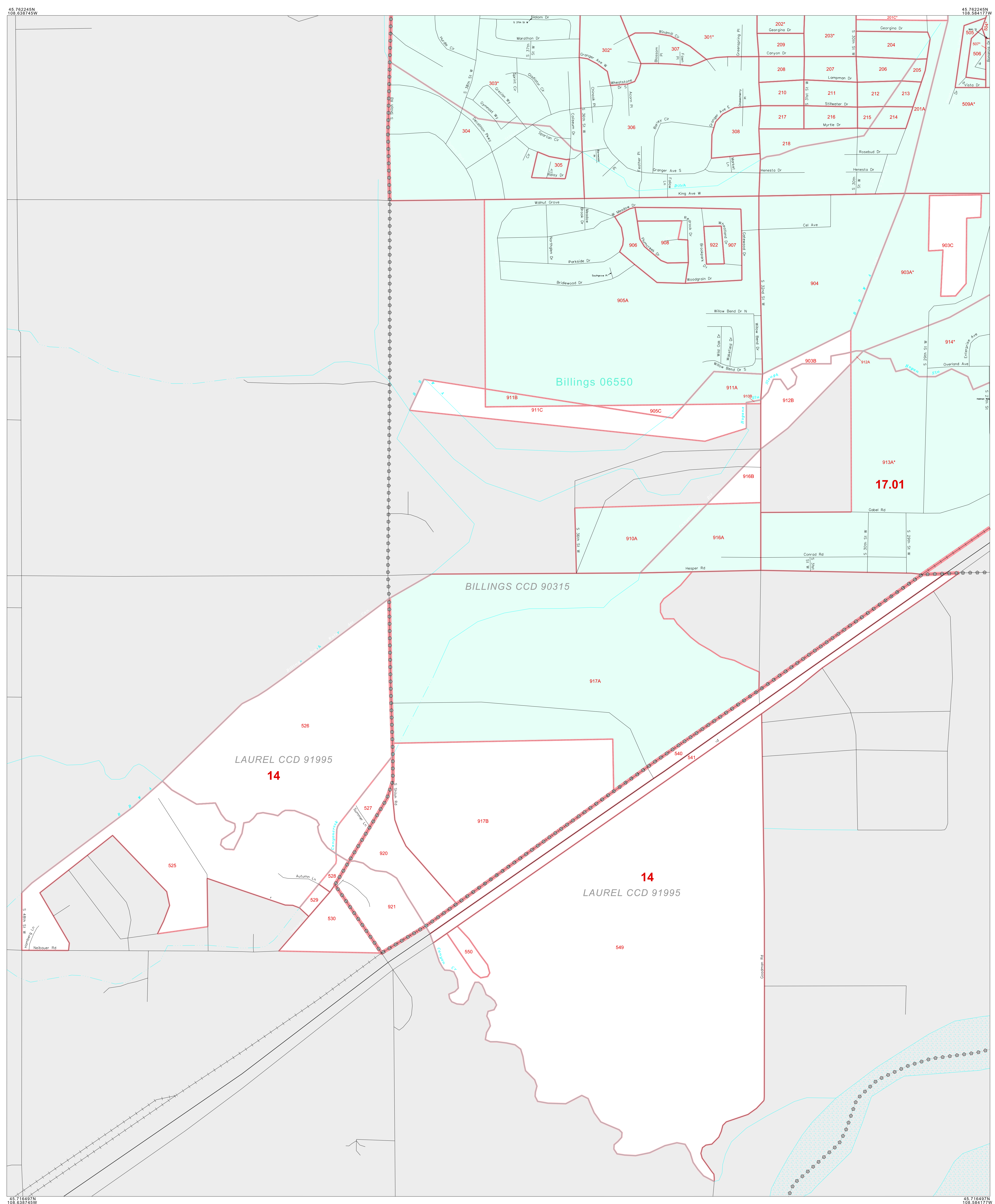

45 716497N  
106 030745W

The plotted map scale is 1:7000

45 716497N  
106 030745W

Key to Adjacent Sheets

E04	E05
E08	E09

Sheet Location within Entity

INSET SHEET E08 of E11  
TOTAL SHEETS: 64 (Index 1; Parent 45; Inset 18)

ENTITY TYPE: County  
NAME: Yellowstone County (111)  
ST: Montana (30)

1990 COUNTY BLOCK MAP (RECREATED)  
PDRDLK 195501169980000000

All legal boundaries and names are as of January 1, 1990 as tabulated for the Public Law 94-171 and Summary Tape File products. The boundaries also reflect the feature network and coordinates as of the Census 2000 geographic base. Since 1990 the Census Bureau updated the base from the North American Datum of 1927 (NAD27) to the datum as of 1983 (NAD83) and made numerous updates to the base features from those depicted in 1990. The boundaries shown on this map are for the Census Bureau's statistical data collection and tabulation purposes only; their depiction and designation for statistical purposes does not constitute a determination of jurisdictional authority or rights or ownership or entitlement. Source: U.S. Census Bureau's TIGER database (Census 2000) Projection: State-based Albers' Equal Area U.S. DEPARTMENT OF COMMERCE Economics and Statistics Administration U.S. Census Bureau