

CENSUS 2000 BLOCK MAP: FLANDREAU Reservation

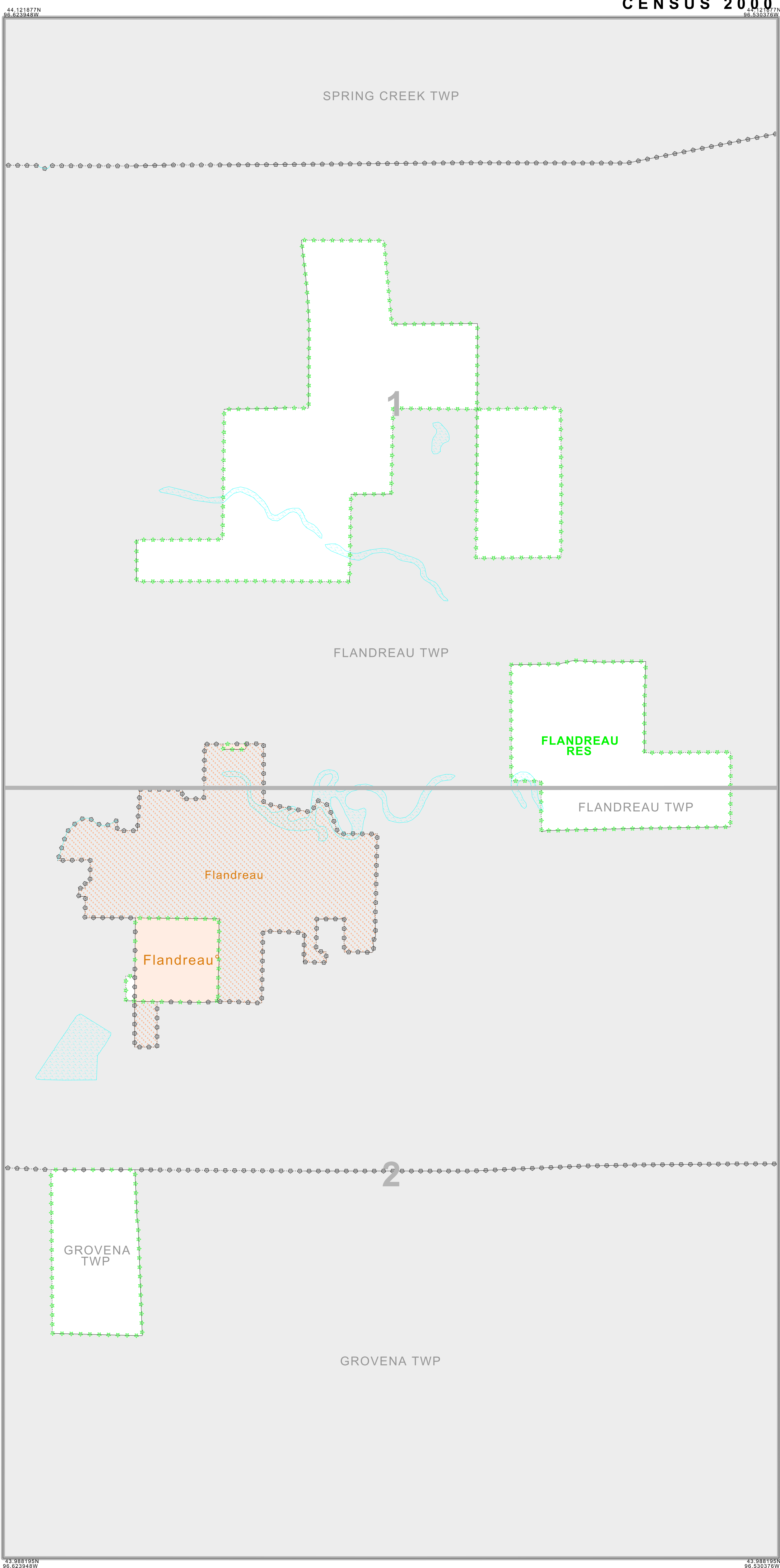

CENSUS 2000 BLOCK MAP LEGEND (for Federally Recognized Tribes with a Legal Land Base)

SYMBOL DESCRIPTION	SYMBOL	NAME STYLE
International	*****	CANADA
American Indian Reservation (Federal)	*****	L'ANSE RES (1880)
Off-Reservation Trust Land, Hawaiian Home Land	*****	T1880
Oklahoma Tribal Statistical Area, Alaska Native Village Statistical Area, Tribal Designated Statistical Area	*****	KAW OTSA (5340)
American Indian Tribal Subdivision	*****	SHONTO (620)
American Indian Reservation (State)	*****	Tama Res (4125)
State Designated American Indian Statistical Area	*****	Lumbee (9815)
Alaska Native Regional Corporation	*****	NANA ANRC 52120
State or Statistically Equivalent Entity	*****	NEW YORK 36
County or Statistically Equivalent Entity	*****	ERIE 029
Minor Civil Division (MCD) ¹	*****	PIKE TWP 59742
Census County Division (CCD)	*****	KULA CCD 91890
Consolidated City	*****	Milford 47500
Incorporated Place ¹ (Within Subject Entity)	*****	Rome 63418
Census Designated Place (CDP) ¹ (Within Subject Entity)	*****	Zena 84187
Place Outside of Subject Entity	*****	
Corporate Offset Boundary	*****	
Tribal Census Tract ²	*****	9401
Census Tract ²	*****	
Census Block ³	*****	1326

FEATURE	SYMBOL	FEATURE	SYMBOL
Interstate or Other Highway	Highway	Perennial Stream or Shoreline	Tumbling Cr.
Secondary Road	Morph. Ln.	Intermittent Stream or Shoreline	Piney Cr.
Jeep Trail, Walkway, Stairway, or Ferry	---	Large River or Lake	Pleasant Lake
Railroad	Southern sp.	Glacier	Bering Glacier
Pipeline or Power Line	---	Military Installation	Fort Snelling
Ridge, Fence, or Other Physical Feature	---	Inset Area	A
Property Line or Fence Line	---	Outside Subject Area	
Nonvisible Boundary or Feature Not Elsewhere Classified	---		

Where international, state, and/or county boundaries coincide, the map shows the boundary symbol for only the highest-ranking of these boundaries.

¹ A " " following a place name indicates that the place is coterminous with a MCD. A " " following an incorporated place name indicates that the place is also a false MCD; the false MCD name is not shown.

² This map shows tribal census tract boundaries and numbers within the subject entity; nontribal census tract boundaries are shown outside of the subject entity but without numbers. A tribal census tract is a type of census tract defined within a federally recognized American Indian reservation or off-reservation trust land for the purpose of providing data based on its American Indian hierarchy rather than by state and county. Where reservations or off-reservation trust lands cross state or county boundaries, the same tribal census tract number may be assigned to both sides of the boundary and, if so, constitutes a single tribal census tract entity.

³ A " " following a block number indicates that the block number is repeated elsewhere in the block.

All legal boundaries and names are as of January 1, 2000. The boundaries shown on this map are for Census Bureau statistical data collection and tabulation purposes only; their depiction and designation for statistical purposes does not constitute a determination of jurisdictional authority or rights of ownership or entitlement. Source: U.S. Census Bureau's TIGER database (Census 2000). Projection: State-based Albers Equal Area. U.S. DEPARTMENT OF COMMERCE Economics and Statistics Administration U.S. Census Bureau

ENTITY TYPE: American Indian Reservation
NAME: Flandreau Reservation (1100)
ST: South Dakota

TOTAL SHEETS: 3 (Index 1; Parent 2; Inset 0)
INDEX FOR CENSUS 2000 BLOCK MAP
(2RGUATR) 42711000000000000000

