

CENSUS 2000 BLOCK MAP: GREENVILLE Rancheria

40 155598N
120 801190W

40 155598N
120 803730W

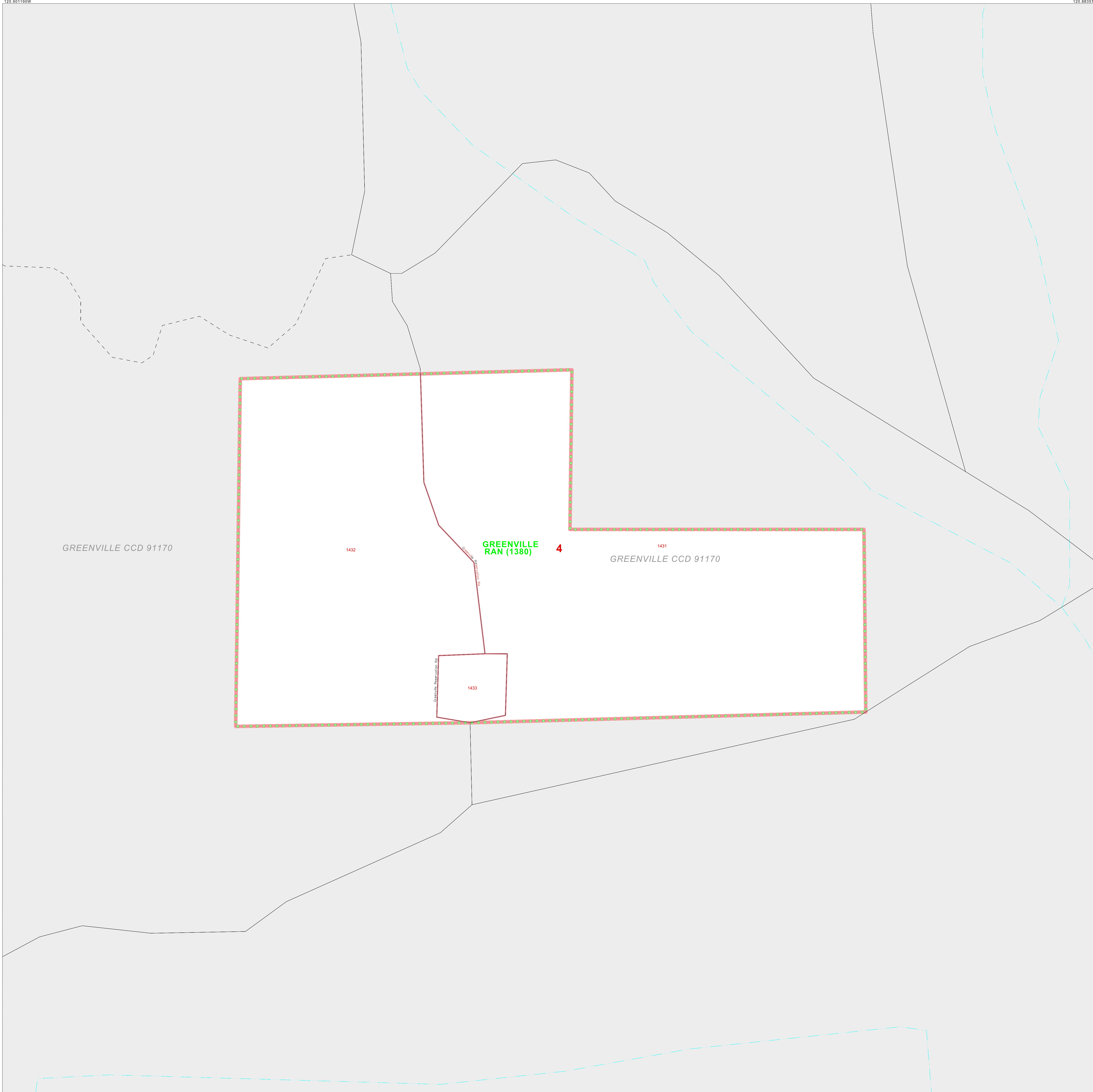

LEGEND

SYMBOL	NAME STYLE
*****	INTERNATIONAL
*****	AIR (FEDERAL)
*****	Trust Land / Home Land
*****	OTSA / TDSA / ANVSA
*****	AMERICAN INDIAN TRIBAL SUBDIVISION
*****	AIR (State)
*****	SDA/SA
*****	ANRC
*****	STATE (or statistically equivalent entity)
*****	COUNTY (or statistically equivalent entity)
*****	MINOR CIVIL DIV. / CCD ¹
*****	Consolidated City
*****	Place within Subject Entity
*****	Incorporated Place / CDP ¹
*****	Place outside of Subject Entity
*****	Incorporated Place / CDP ¹
*****	Corporate Offset Boundary
*****	Tribal Census Tract ²
*****	Census Tract ³
*****	CENSUS BLOCK ³

ABBREVIATION REFERENCE: AIR - American Indian Reservation; Trust Land - Off-Reservation Trust Land; Home Land - Hawaiian Home Land; OTSA - Oklahoma Tribal Statistical Area; TDSA - Tribal Designated Statistical Area; ANVSA - Alaska Native Village Statistical Area; SDA/SA - State Designated American Indian Statistical Area; ANRC - Alaska Native Regional Corporation; CDP - Census Designated Place; Minor Civil Div. (MCD) - Minor Civil Division; CCD - Census County Division

FEATURES

Highway	Pipe/Power Line	Stream/Shoal
Secondary Road	Ridge/Physical Feature	Intermittent Stream
Deep Trench/Wetway/Ferry	Property/Fence Line	River/Lake
Rollroad	Nonvisible Boundary	Glacier

Mosaic Inset Out Area

Where international, state, and/or county boundaries coincide, the map shows the boundary symbol for only the highest ranking of these boundaries.
¹ A "*" following a place name indicates that the place is coextensive with a MCD. A "-" indicates that the place is also a false MCD; the false MCD name is not shown.
² This map shows tribal census tract boundaries and numbers within the subject entity; nontribal census tract boundaries are shown outside of the subject entity but without numbers. A tribal census tract is a type of census tract defined within a federally recognized American Indian reservation or off-reservation trust land for the purpose of providing data based on an American Indian hierarchy rather than by state and county. Where reservations or off-reservation trust lands cross a state or county boundary, the same tribal census tract number may be assigned on both sides of the boundary, and, if so, constitutes a single tribal census tract entity.
³ A "*" following a block number indicates that the block number is repeated elsewhere in the block.

Key to Adjacent Sheets

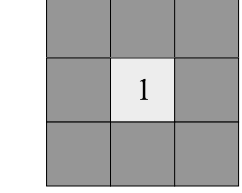

SHEET 1 OF 1 PARENT SHEET
TOTAL SHEETS: 1 (Index 0; Parent 1; Inset 0)

