

CENSUS 2000 BLOCK MAP: BROWARD County

26 356243N
80 317237W

26 356243N
80 264830W

LEGEND

- | SYMBOL | NAME STYLE |
|--------|---|
| ***** | INTERNATIONAL |
| ***** | AIR (FEDERAL) |
| ***** | Trust Land / Home Land |
| ***** | OTSA / TDSA / ANVSA |
| ***** | AMERICAN INDIAN TRIBAL SUBDIVISION |
| ***** | AIR (State) |
| ***** | SDA/SA |
| ***** | ANRC |
| ***** | STATE (or statistically equivalent entity) |
| ***** | COUNTY (or statistically equivalent entity) |
| ***** | MINOR CIVIL DIV. / CCD ¹ |
| ***** | Consolidated City |
| ***** | Place within Subject Entity |
| ***** | Incorporated Place / CDP ¹ |
| ***** | Place outside of Subject Entity |
| ***** | Incorporated Place / CDP ¹ |
| ***** | Corporate Offset Boundary |
| ***** | Census Tract |
| ***** | BLOCK² |

ABBREVIATION REFERENCE: AIR = American Indian Reservation; Trust Land = Off-Reservation Trust Land; Home Land = Hawaiian Home Land; OTSA = Oklahoma Tribal Statistical Area; TDSA = Tribal Designated Statistical Area; ANVSA = Alaska Native Village Statistical Area; SDA/SA = State Designated American Indian Statistical Area; ANRC = Alaska Native Regional Corporation; CDP = Census Designated Place; Minor Civil Div. (MCD) = Minor Civil Division; CCD = Census County Division

- FEATURES
- | | | |
|--------------------------|------------------------|---------------------|
| Highway | Pipe/Power Line | Stream/Shoreline |
| Secondary Road | Ridge/Physical Feature | Intermittent Stream |
| Deep Trail/Highway/Ferry | Property/Fence Line | River/Lake |
| Railroad | Nonvisible Boundary | Glacier |
- Inset Out Area

Where international, state, and/or county boundaries coincide, the map shows the boundary symbol for only the highest-ranking of these boundaries.
¹ A "*" following a place name indicates that the place is coextensive with a MCD. A "*" indicates that the place is also a false MCD; the false MCD name is not shown.
² A "*" following a block number indicates that the block number is repeated elsewhere in the block.

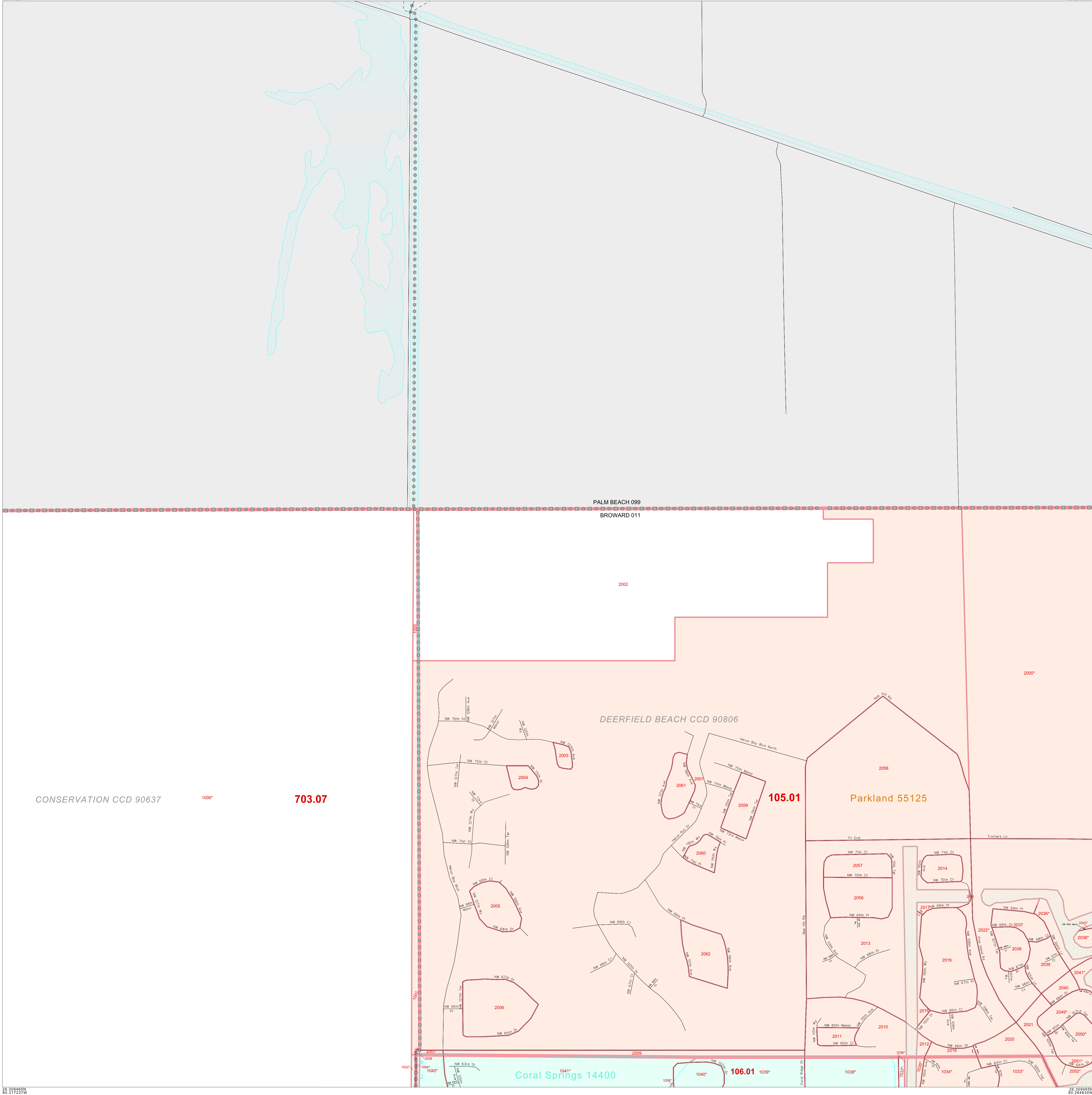

26 356243N
80 317237W

26 356243N
80 264830W

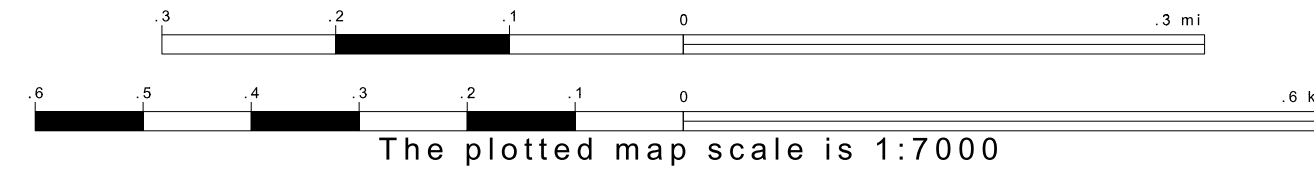

ENTITY TYPE: County
 NAME: Broward County (011)
 ST: Florida (12)



All legal boundaries and names are as of January 1, 2000. The boundaries shown on this map are for Census Bureau statistical data collection and tabulation purposes only; their depiction and designation for statistical purposes does not constitute a determination of jurisdictional authority or rights of ownership or entitlement. Source: U.S. Census Bureau's TIGER database (Census 2000) Projection: State-based Albers' Equal Area U.S. DEPARTMENT OF COMMERCE Economics and Statistics Administration U.S. Census Bureau

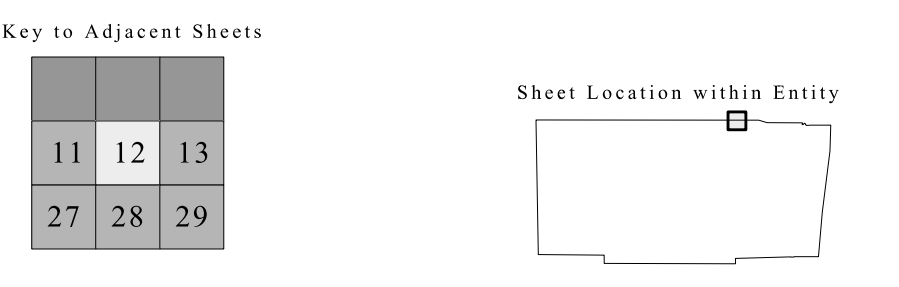

SHEET 12 OF 141 PARENT SHEETS
 TOTAL SHEETS: 146 (Index 1; Parent 141; Inset 4)