

CENSUS 2000 BLOCK MAP: COLLIER County

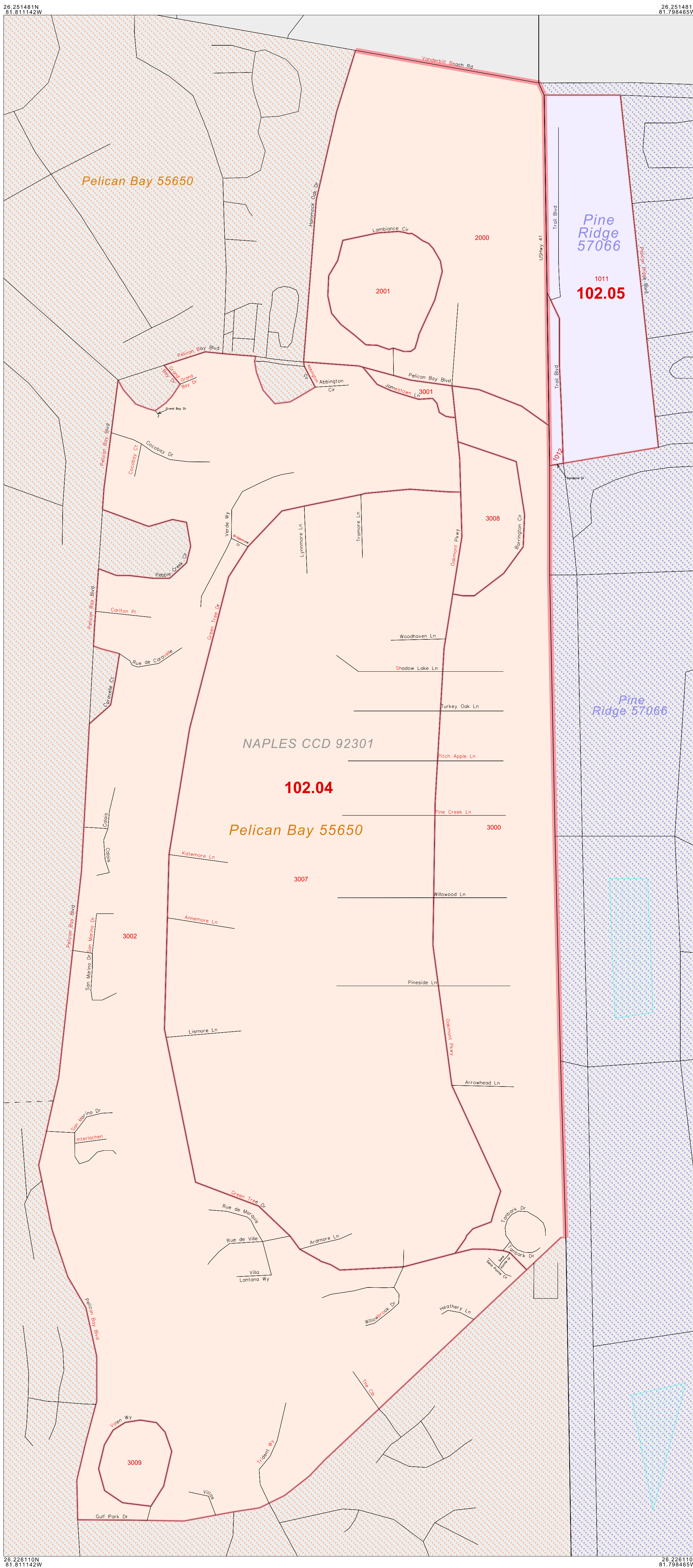

Key to Adjacent Sheets

G01

Sheet Location within Entity

INSET SHEET G01 of G01
 TOTAL SHEETS: 65 (Index 1; Parent 36; Inset 28)

All legal boundaries and names are as of January 1, 2000. The boundaries shown on this map are for Census Bureau statistical data collection and tabulation purposes only; their depiction and designation for statistical purposes does not constitute a determination of jurisdictional authority or rights of ownership or entitlement. Source: U.S. Census Bureau's TIGER database (Census 2000). Projection: State-based Albers' Equal Area. U.S. DEPARTMENT OF COMMERCE Economics and Statistics Administration U.S. Census Bureau

ENTITY TYPE: County
 NAME: Collier County (021)
 ST: Florida (12)

