

CENSUS 2000 BLOCK MAP: INDIAN RIVER County

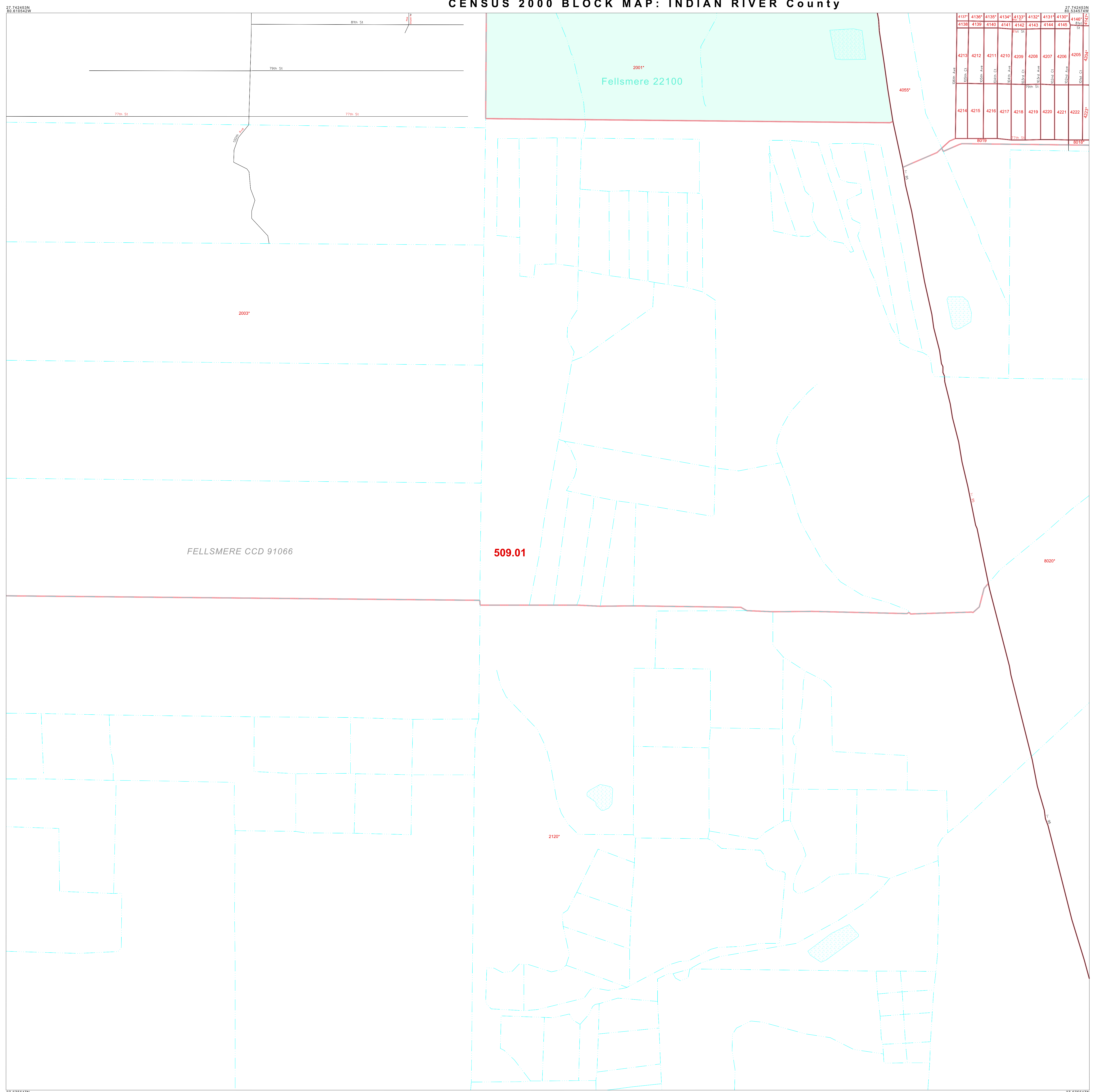

Grid of block numbers in the top right corner, including 4137, 4138, 4139, 4140, 4141, 4142, 4143, 4144, 4145, 4201, 4202, 4203, 4204, 4205, 4206, 4207, 4208, 4209, 4210, 4211, 4212, 4213, 4214, 4215, 4216, 4217, 4218, 4219, 4220, 4221, 4222.

LEGEND section with SYMBOL and NAME STYLE columns, listing categories like INTERNATIONAL, AIR (FEDERAL), Trust Land / Home Land, OTSA / TDSA / ANVSA, AMERICAN INDIAN TRIBAL SUBDIVISION, AIR (State), SDA/SA, ANRC, STATE, COUNTY, MINOR CIVIL DIV., Consolidated City, Incorporated Place / CDP, etc.

ABBREVIATION REFERENCE: AIR - American Indian Reservation; Trust Land - Off-Reservation Trust Land; Home Land - Hawaiian Home Land; OTSA - Oklahoma Tribal Statistical Area; TDSA - Tribal Designated Statistical Area; ANVSA - Alaska Native Village Statistical Area; SDA/SA - State Designated American Indian Statistical Area; ANRC - Alaska Native Regional Corporation; CDP - Census Designated Place; Minor Civil Div. (MCD) - Minor Civil Division; CCD - Census County Division

FEATURES section with symbols for Highway, Secondary Road, Deep Trail/Roadway/Ferry, Railroad, Pipe/Power Line, Ridge/Physical Feature, Property/Fence Line, Nonvisible Boundary, Stream/Shoreline, Intermittent Stream, River/Arroyo, Glacier, and an Inset/Out Area box.

Where international, state, and/or county boundaries coincide, the map shows the boundary symbol for only the highest-ranking of these boundaries. 1 A "1" following a place name indicates that the place is coterminous with a MCD. A "2" indicates that the place is also a false MCD; the false MCD name is not shown. 2 A "2" following a block number indicates that the block number is repeated elsewhere in the block.

Key to Adjacent Sheets (grid 11-28) and Sheet Location within Entity (map outline with a highlighted square).

SHEET 19 OF 37 PARENT SHEETS TOTAL SHEETS: 41 (Index 1; Parent 37; Inset 3)