

CENSUS 2000 BLOCK MAP: PALM BEACH County

26 846360N  
80 317586W

26 846360N  
80 242464W

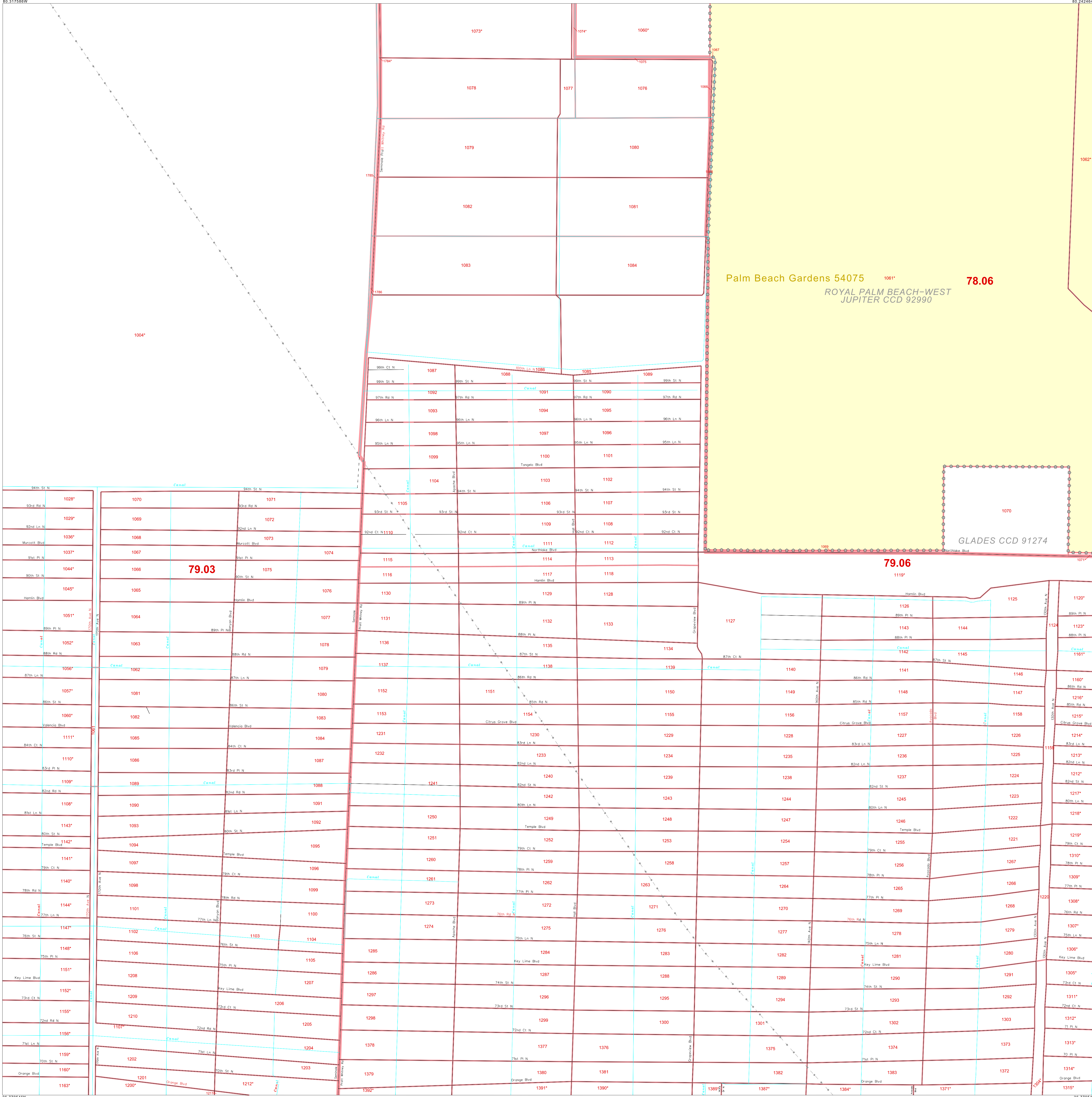

**LEGEND**

**SYMBOL NAME STYLE**

- \*\*\*\*\* INTERNATIONAL
- \*\*\*\*\* AIR (FEDERAL)
- \*\*\*\*\* Trust Land / Home Land
- \*\*\*\*\* OTSA / TDSA / ANVSA
- \*\*\*\*\* AMERICAN INDIAN TRIBAL SUBDIVISION
- \*\*\*\*\* AIR (State)
- \*\*\*\*\* SDAISA
- \*\*\*\*\* ANRC
- \*\*\*\*\* STATE (or statistically equivalent entity)
- \*\*\*\*\* COUNTY (or statistically equivalent entity)
- \*\*\*\*\* MINOR CIVIL DIV. / CCD<sup>1</sup>
- \*\*\*\*\* Consolidated City
- \*\*\*\*\* Incorporated Place / CDP<sup>1</sup>
- \*\*\*\*\* Place within Subject Entity
- \*\*\*\*\* Incorporated Place / CDP<sup>1</sup>
- \*\*\*\*\* Place outside of Subject Entity
- \*\*\*\*\* Incorporated Place / CDP<sup>1</sup>
- \*\*\*\*\* Corporate Offset Boundary
- Census Tract**
- BLOCK<sup>2</sup>**

**ABBREVIATION REFERENCE:** AIR = American Indian Reservation; Trust Land = Off-Reservation Trust Land; Home Land = Hawaiian Home Land; OTSA = Oklahoma Tribal Statistical Area; TDSA = Tribal Designated Statistical Area; ANVSA = Alaska Native Village Statistical Area; SDAISA = State Designated American Indian Statistical Area; ANRC = Alaska Native Regional Corporation; CDP = Census Designated Place; Minor Civil Div. (MCD) = Minor Civil Division; CCD = Census County Division

**FEATURES**

- Highway
- Secondary Road
- Deep Trail/Pathway/Ferry
- Roadway
- Pipe/Power Line
- Ridge/Physical Feature
- Property/Fence Line
- Nonvisible Boundary
- Stream/Shoreline
- Intermittent Stream
- River/Arroyo
- Creeper

Where international, state, and/or county boundaries coincide, the map shows the boundary symbol for only the highest-ranking of these boundaries.  
<sup>1</sup> A " " following a place name indicates that the place is coextensive with a MCD. A " " indicates that the place is also a false MCD; the false MCD name is not shown.  
<sup>2</sup> A " " following a block number indicates that the block number is repeated elsewhere in the block.

**Inset** **Out Area**

26 778646N  
80 317586W

26 778646N  
80 242464W

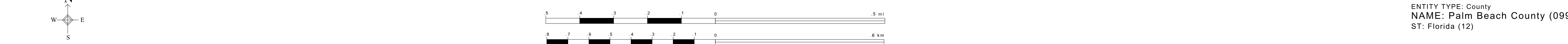

The plotted map scale is 1:10000

ENTITY TYPE: County  
NAME: Palm Beach County (099)  
ST: Florida (12)

Key to Adjacent Sheets

13	14	15
23	24	25
35	36	37

Sheet Location within Entity

SHEET 24 OF 111 PARENT SHEETS  
TOTAL SHEETS: 133 (Index 1; Parent 111; Inset 21)

All legal boundaries and names are as of January 1, 2000. The boundaries shown on this map are for Census Bureau statistical data collection and tabulation purposes only; their depiction and designation for statistical purposes does not constitute a determination of jurisdictional authority or rights of ownership or entitlement. Source: U.S. Census Bureau's TIGER database (Census 2000). Projection: State-based Albers' Equal Area U.S. DEPARTMENT OF COMMERCE Economics and Statistics Administration U.S. Census Bureau

