

CENSUS 2000 BLOCK MAP: PASCO County

28 495161N
82 286955W

28 495161N
82 222018W

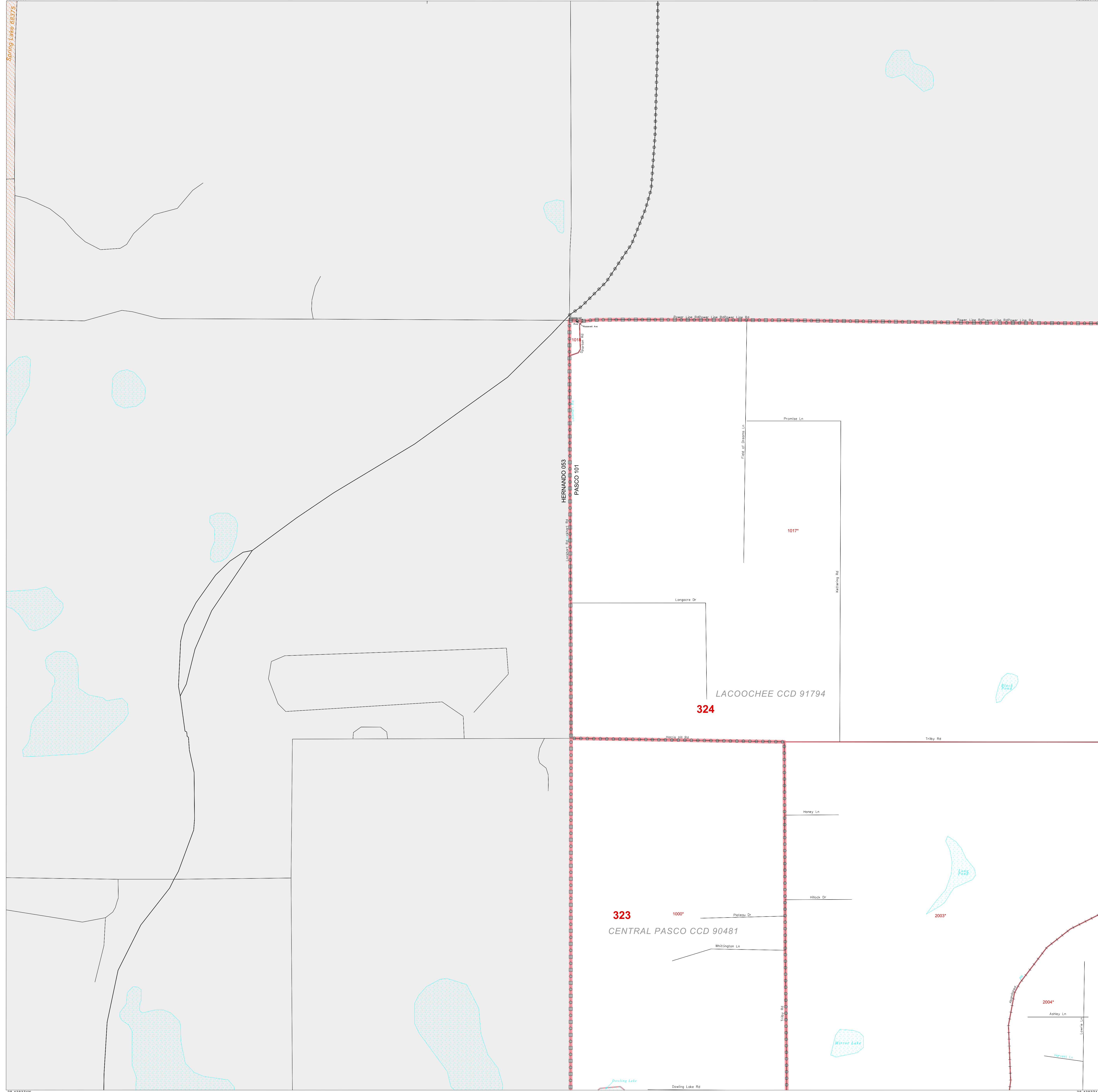

28 495161N
82 286955W

28 495161N
82 222018W

All legal boundaries and names are as of January 1, 2000. The boundaries shown on this map are for Census Bureau statistical data collection and tabulation purposes only; their depiction and designation for statistical purposes does not constitute a determination of jurisdictional authority or rights of ownership or entitlement. Source: U.S. Census Bureau's TIGER database (Census 2000). Projection: State-based Albers' Equal Area. U.S. DEPARTMENT OF COMMERCE Economics and Statistics Administration U.S. Census Bureau

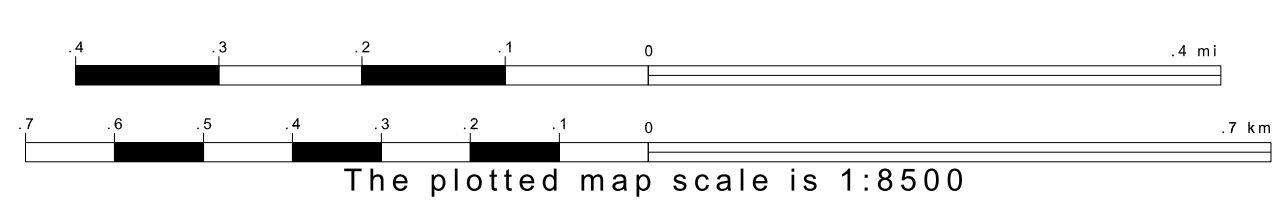

ENTITY TYPE: County
 NAME: Pasco County (101)
 ST: Florida (12)

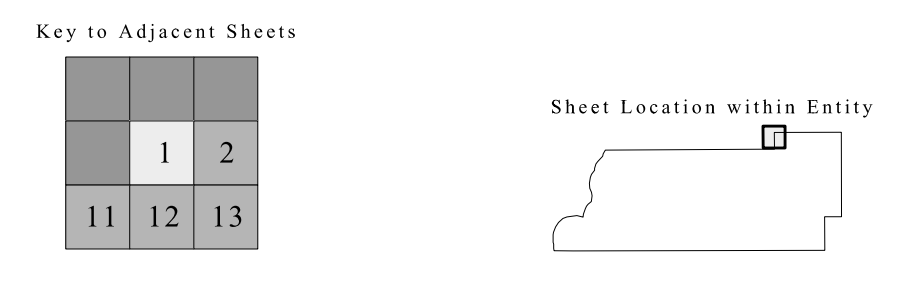

SHEET 1 OF 63 PARENT SHEETS
 TOTAL SHEETS: 73 (Index 1; Parent 63; Inset 9)

