

CENSUS 2000 BLOCK MAP: CLEARWATER CCD

**LEGEND**

SYMBOL	NAME STYLE
*****	INTERNATIONAL
*****	AIR (FEDERAL)
*****	Trust Land / Home Land
*****	OTSA / TDSA / ANVSA
*****	AMERICAN INDIAN TRIBAL SUBDIVISION
//////	AIR (State)
◇◇◇◇◇	SDA/SA
▽▽▽▽▽	ANRC
//////	STATE (or statistically equivalent entity)
□□□□□	COUNTY (or statistically equivalent entity)
○ ○ ○ ○ ○	MINOR CIVIL DIV. / CCD <sup>1</sup>
○ ○ ○ ○ ○	Consolidated City
□ □ □ □ □	Place within Subject Entity
□ □ □ □ □	Incorporated Place / CDP <sup>1</sup>
□ □ □ □ □	Place outside of Subject Entity
□ □ □ □ □	Incorporated Place / CDP <sup>1</sup>
-----	Corporate Offset Boundary
-----	Census Tract
-----	BLOCK <sup>2</sup>

**ABBREVIATION REFERENCE:** AIR = American Indian Reservation; Trust Land = Off-Reservation Trust Land; Home Land = Hawaiian Home Land; OTSA = Oklahoma Tribal Statistical Area; TDSA = Tribal Designated Statistical Area; ANVSA = Alaska Native Village Statistical Area; SDA/SA = State Designated American Indian Statistical Area; ANRC = Alaska Native Regional Corporation; CDP = Census Designated Place; Minor Civil Div. (MCD) = Minor Civil Division; CCD = Census County Division

**FEATURES**

Highway	Pipe/Power Line	Stream/Shoreline
Secondary Road	Ridge/Physical Feature	Intermittent Stream
Deep Trail/Pathway/Ferry	Property/Fence Line	River/Lake
Railroad	Nonvisible Boundary	Glacier

Where international, state, and/or county boundaries coincide, the map shows the boundary symbol for only the highest-ranking of these boundaries.  
<sup>1</sup> A " " following a place name indicates that the place is coextensive with a MCD. A " " indicates that the place is also a false MCD; the false MCD name is not shown.  
<sup>2</sup> A " " following a block number indicates that the block number is repeated elsewhere in the block.

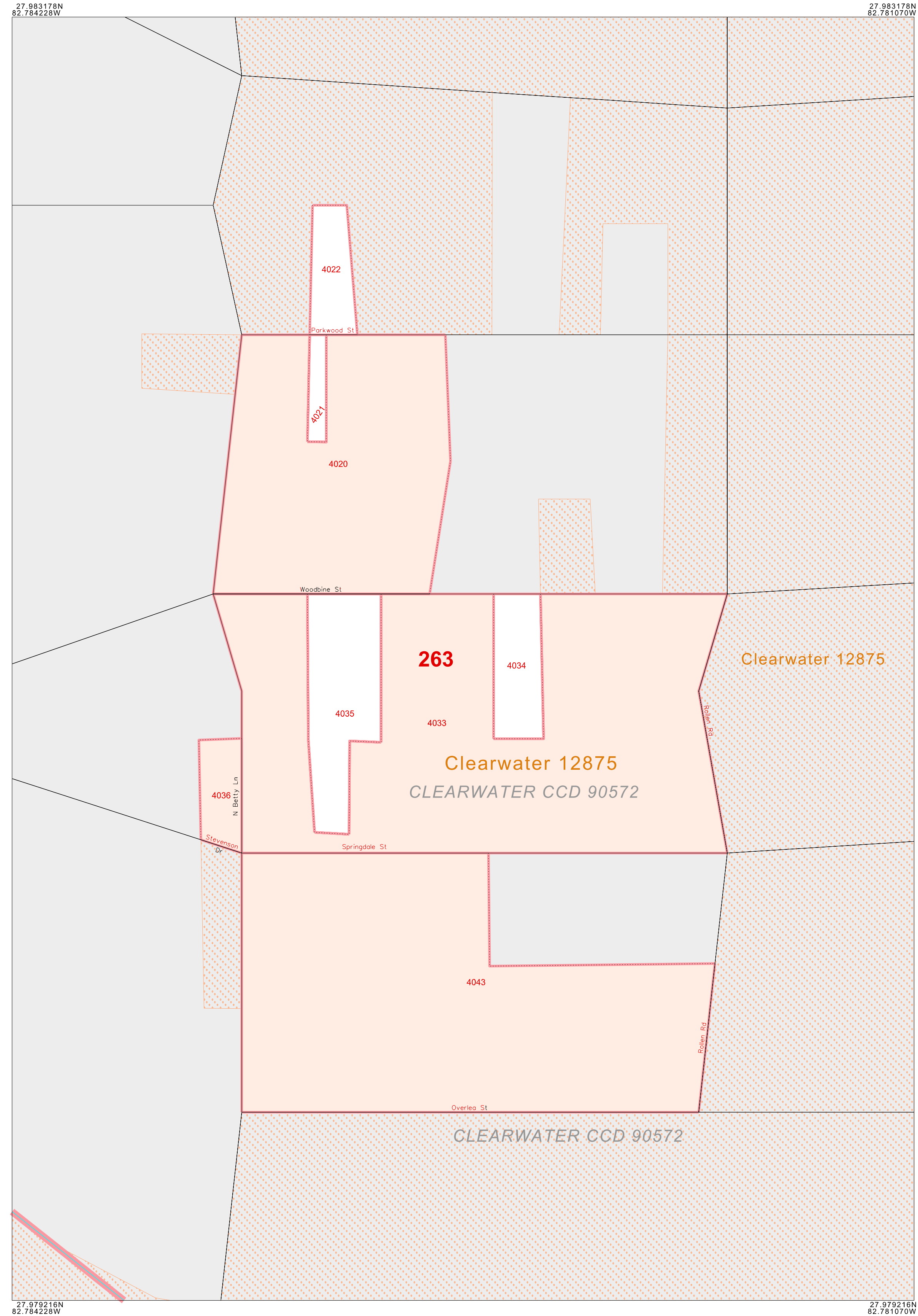

27 883178N  
82 784228W

27 883178N  
82 781070W

27 878216N  
82 784228W

27 878216N  
82 781070W

N  
W E  
S

90 80 70 60 50 40 30 20 10 0 90 yd  
80 70 60 50 40 30 20 10 0 80 m

The plotted map scale is 1:1000

ENTITY TYPE: Census County Division  
 NAME: Clearwater CCD (90572)  
 ST: Florida (12)  
 CO: Pinellas Co (103)

CENSUS 2000 BLOCK MAP  
 (SEQUENT) 4141295720901000000

Key to Adjacent Sheets

Sheet Location within Entity

INSET SHEET E01 of E01  
 TOTAL SHEETS: 40 (Index 1; Parent 28; Inset 11)

All legal boundaries and names are as of January 1, 2000. The boundaries shown on this map are for Census Bureau statistical data collection and tabulation purposes only; their depiction and designation for statistical purposes does not constitute a determination of jurisdictional authority or rights of ownership or entitlement. Source: U.S. Census Bureau's TIGER database (Census 2000) Projection: State-based Albers' Equal Area U.S. DEPARTMENT OF COMMERCE Economics and Statistics Administration U.S. Census Bureau