

CENSUS 2000 BLOCK MAP: FROSTPROOF CCD

CENSUS 2000 BLOCK MAP LEGEND		
SYMBOL DESCRIPTION	SYMBOL	NAME STYLE
International	*****	CANADA
American Indian Reservation (Federal)	*****	L'ANSE RES (1880)
Off-Reservation Trust Land, Hawaiian Home Land	*****	T1880
Oklahoma Tribal Statistical Area, Alaska Native Village Statistical Area, Tribal Designated Statistical Area	*****	KAW OTSA (5340)
American Indian Tribal Subdivision	*****	SHONTO (620)
American Indian Reservation (State)	*****	Tama Res (4125)
State Designated American Indian Statistical Area	*****	Lumbee (9815)
Alaska Native Regional Corporation	*****	NANA ANRC 52120
State or Statistically Equivalent Entity	*****	NEW YORK 36
County or Statistically Equivalent Entity	*****	ERIE 029
Minor Civil Division (MCD) ¹	*****	PIKE TWP 59742
Census County Division (CCD)	*****	KULA CCD 91890
Consolidated City	*****	Milford 47500
Incorporated Place ¹ (Within Subject Entity)	*****	Rome 63418
Census Designated Place (CDP) ¹ (Within Subject Entity)	*****	Zena 84187
Place Outside of Subject Entity	*****	
Corporate Offset Boundary	*****	
Census Tract	*****	5702.01
Block ²	*****	1326

FEATURE	SYMBOL	FEATURE	SYMBOL
Interstate or Other Highway	Highway	Perennial Stream or Shoreline	Tambling Cr.
Secondary Road	Morph. Ln.	Intermittent Stream or Shoreline	Piney Cr.
Jeep Trail, Walkway, Stairway, or Ferry		Large River or Lake	Pleasant Lake
Railroad	Southern RR	Glacier	Boring Glacier
Pipeline or Power Line		Military Installation	Fort Babine
Ridge, Fence, or Other Physical Feature		Inset Area	A
Property Line or Fence Line		Outside Subject Area	
Nonvisible Boundary or Feature Not Elsewhere Classified			

Where international, state, and/or county boundaries coincide, the map shows the boundary symbol for only the highest-ranking of these boundaries.

¹ A " " following a place name indicates that the place is coterminous with a MCD. A " " following an incorporated place name indicates that the place is also a CDP; the CDP name is not shown.

² A " " following a block number indicates that the block number is repeated elsewhere in the block.

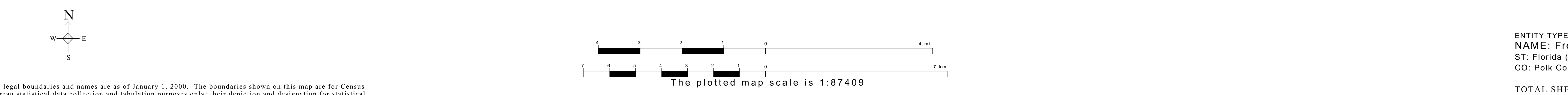
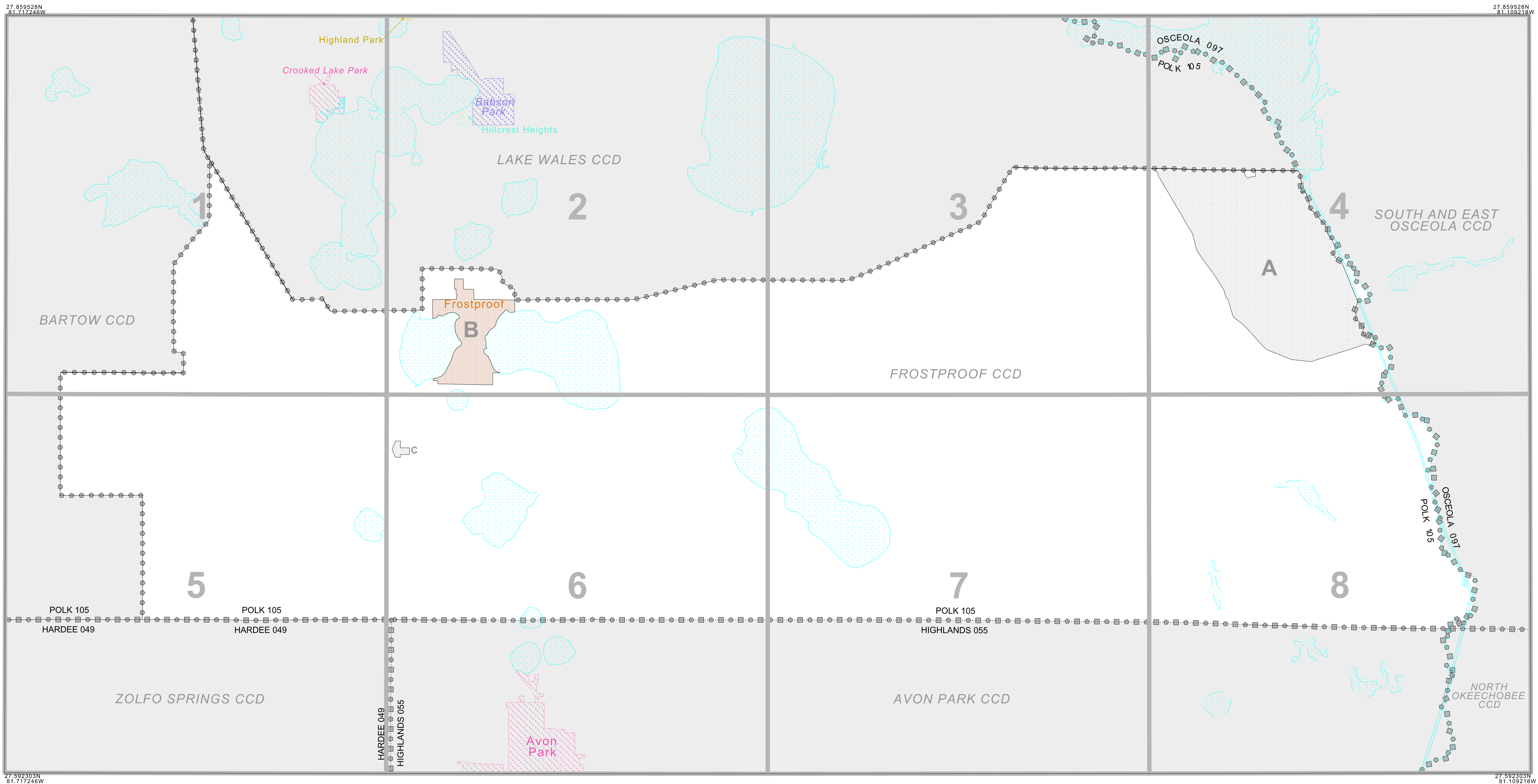

All legal boundaries and names are as of January 1, 2000. The boundaries shown on this map are for Census Bureau statistical data collection and tabulation purposes only; their depiction and designation for statistical purposes does not constitute a determination of jurisdictional authority or rights of ownership or entitlement. Source: U.S. Census Bureau's TIGER database (Census 2000). Projection: State-based Albers' Equal Area. U.S. DEPARTMENT OF COMMERCE Economics and Statistics Administration U.S. Census Bureau

ENTITY TYPE: Census County Division
 NAME: Frostproof CCD (91209)
 ST: Florida (12)
 CO: Polk Co (105)

TOTAL SHEETS: 12 (Index 1; Parent 8; Inset 3)
 INDEX FOR CENSUS 2000 BLOCK MAP
 (SEQUENT) 4241291209000000000