

# CENSUS 2000 BLOCK MAP: ROSEBUD County

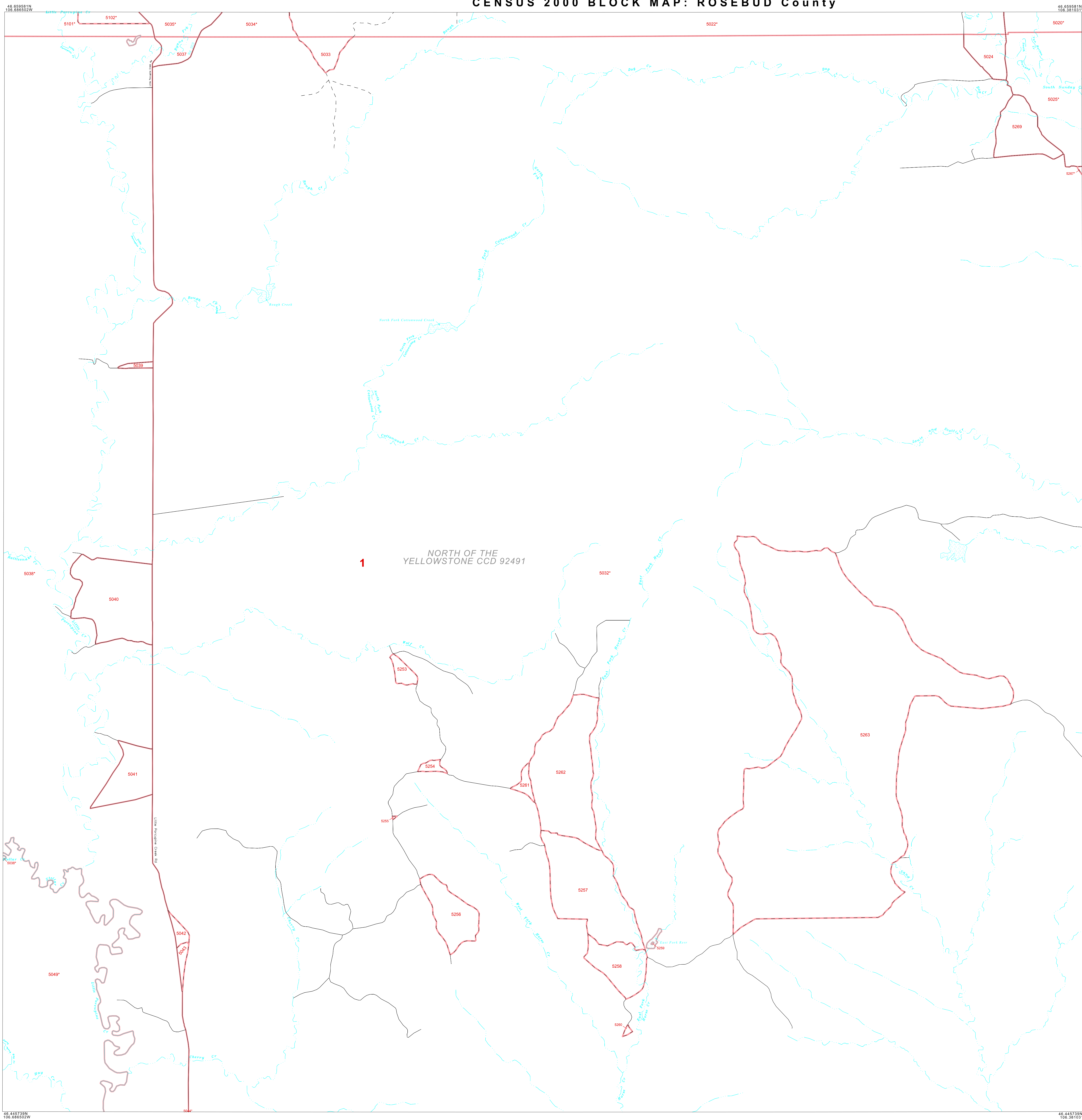

### LEGEND

| SYMBOL | NAME STYLE                                  |
|--------|---------------------------------------------|
| *****  | INTERNATIONAL                               |
| *****  | AIR (FEDERAL)                               |
| *****  | Trust Land / Home Land                      |
| *****  | OTSA / TDSA / ANVSA                         |
| *****  | AMERICAN INDIAN TRIBAL SUBDIVISION          |
| *****  | AIR (State)                                 |
| *****  | SDA/ISA                                     |
| *****  | ANRC                                        |
| -----  | STATE (or statistically equivalent entity)  |
| -----  | COUNTY (or statistically equivalent entity) |
| -----  | MINOR CIVIL DIV. / CCD <sup>1</sup>         |
| -----  | Consolidated City                           |
| -----  | Place within Subject Entity                 |
| -----  | Incorporated Place / CDP <sup>1</sup>       |
| -----  | Place outside of Subject Entity             |
| -----  | Incorporated Place / CDP <sup>1</sup>       |
| -----  | Corporate Offset Boundary                   |
| -----  | <b>Census Tract</b>                         |
| -----  | <b>Block<sup>2</sup></b>                    |

**ABBREVIATION REFERENCE:** AIR = American Indian Reservation; Trust Land = Off-Reservation Trust Land; Home Land = Hawaiian Home Land; OTSA = Oklahoma Tribal Statistical Area; TDSA = Tribal Designated Statistical Area; ANVSA = Alaska Native Village Statistical Area; SDASA = State Designated American Indian Statistical Area; ANRC = Alaska Native Regional Corporation; CDP = Census Designated Place; Minor Civil Div. (MCD) = Minor Civil Division; CCD = Census County Division

### FEATURES

|                          |                        |                     |
|--------------------------|------------------------|---------------------|
| Highway                  | Pipe/Power Line        | Stream/Shoreline    |
| Secondary Road           | Ridge/Physical Feature | Intermittent Stream |
| Deep Trail/Pathway/Ferry | Property/Fence Line    | River/Lake          |
| Railroad                 | Nonvisible Boundary    | Glacier             |

Where international, state, and/or county boundaries coincide, the map shows the boundary symbol for only the highest-ranking of these boundaries.  
<sup>1</sup> A "\*" following a place name indicates that the place is coterminous with a MCD. A "-" indicates that the place is also a false MCD; the false MCD name is not shown.  
<sup>2</sup> A "\*" following a block number indicates that the block number is repeated elsewhere in the block.

Key to Adjacent Sheets

|    |    |    |
|----|----|----|
| 4  | 5  | 6  |
| 10 | 11 | 12 |
| 14 | 15 | 16 |

Sheet Location within Entity

SHEET 11 OF 32 PARENT SHEETS  
 TOTAL SHEETS: 47 (Index 1; Parent 32; Inset 14)

48 445735N  
 106 866502W

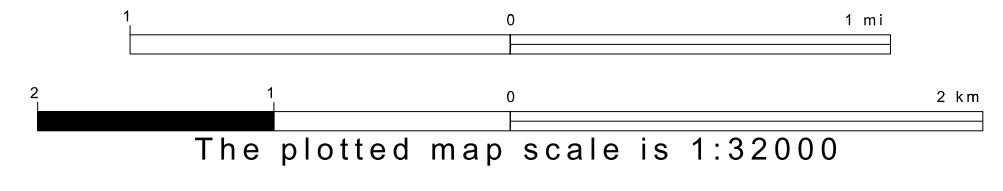
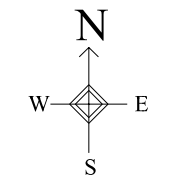

ENTITY TYPE: County  
 NAME: Rosebud County (087)  
 ST: Montana (30)



All legal boundaries and names are as of January 1, 2000. The boundaries shown on this map are for Census Bureau statistical data collection and tabulation purposes only; their depiction and designation for statistical purposes does not constitute a determination of jurisdictional authority or rights of ownership or entitlement. Source: U.S. Census Bureau's TIGER database (Census 2000) Projection: State-based Albers' Equal Area U.S. DEPARTMENT OF COMMERCE Economics and Statistics Administration U.S. Census Bureau