

P. L. 94-171 COUNTY BLOCK MAP (CENSUS 2000)

41 737230N
96.447103W

41 737230N
96.270564W

GEOGRAPHIC AREAS LEGEND

| SYMBOL | NAME STYLE |
|--------|--------------------------------------|
| ***** | INTERNATIONAL |
| ***** | AIR (FEDERAL) |
| ***** | Trust Land |
| ***** | TRIBAL SUBDIVISION |
| ////// | STATE |
| | COUNTY |
| ----- | MINOR CIVIL DIV. ¹ |
| ----- | Incorporated Place ¹ |
| ----- | Census Designated Place ¹ |
| ----- | Corporate Offset Boundary |
| | Voting District ² |
| ----- | Census Tract |
| ----- | BLOCK ³ |
| ----- | Military ² |
| ----- | Inset |
| ----- | Out Area |

Abbreviation Reference: AIR = American Indian Reservation; Trust Land = OTL; Reservation Trust Land; Tribal Subdivision = American Indian Tribal Subdivision

1 A * * following a place name indicates that the place is consecutive with a MCD. A * * indicates that the place is also a false MCD. In both cases, the MCD name is shown only when it differs from the place name.

2 A * * following a VTD code indicates an actual voting district. Its absence indicates that the VTD is a pseudo voting district or no information is available as to its status.

3 A * * following a block number indicates that the block number is repeated elsewhere in the block.

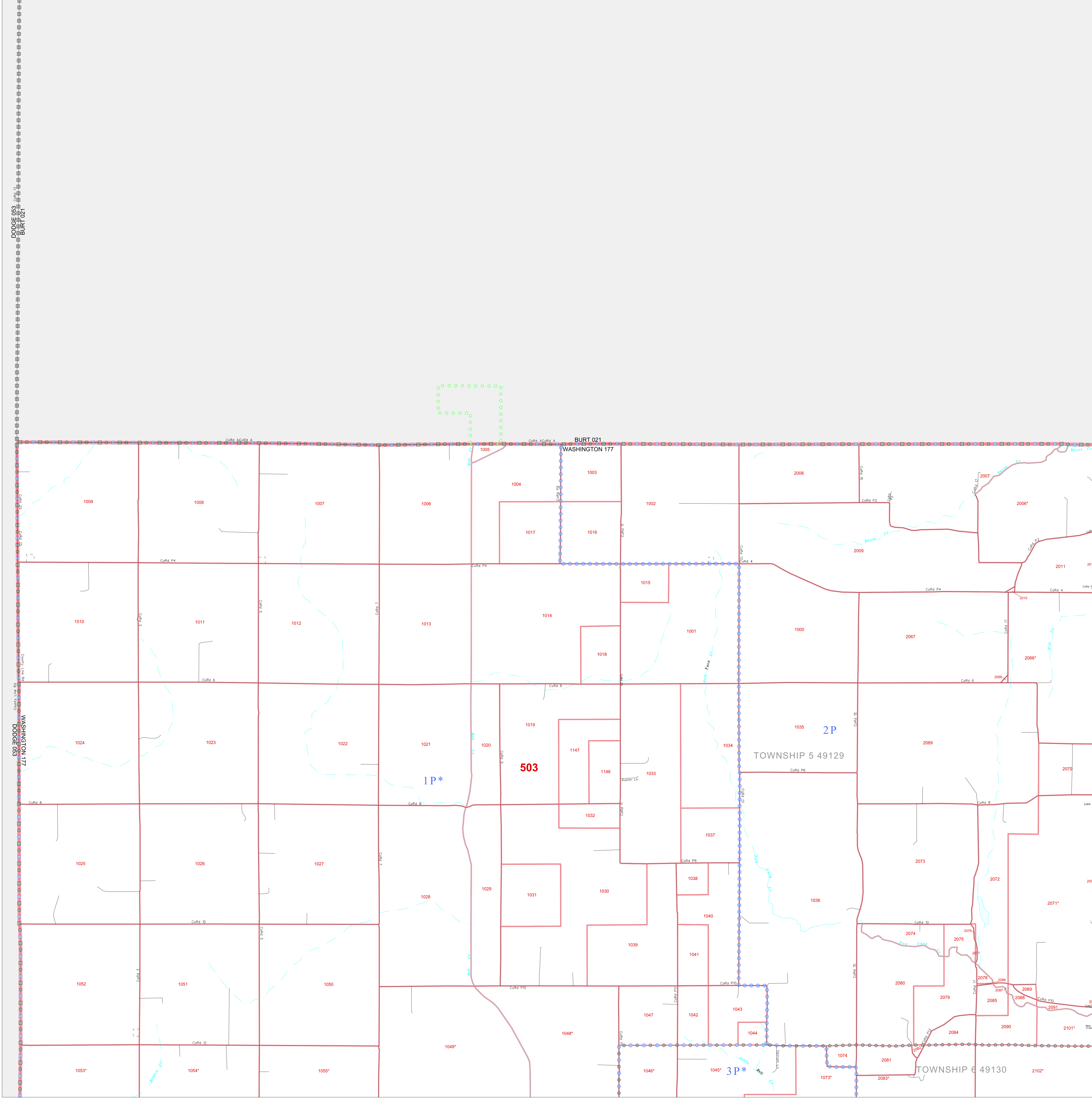

41 604593N
96.447103W

41 604593N
96.270564W

Sheet Location within County

Key to Adjacent Sheets

| | |
|---|---|
| 1 | 2 |
| 3 | 4 |

The plotted map scale is 1:20000

1.0 mi

1 km

All legal boundaries and names are as of January 1, 2000. The boundaries shown on this map are for Census Bureau statistical data collection and tabulation purposes only; their depiction and designation for statistical purposes does not constitute a determination of jurisdictional authority or rights of ownership or entitlement. U.S. DEPARTMENT OF COMMERCE Economics and Statistics Administration U.S. Census Bureau