

P.L. 94-171 COUNTY BLOCK MAP (CENSUS 2000)

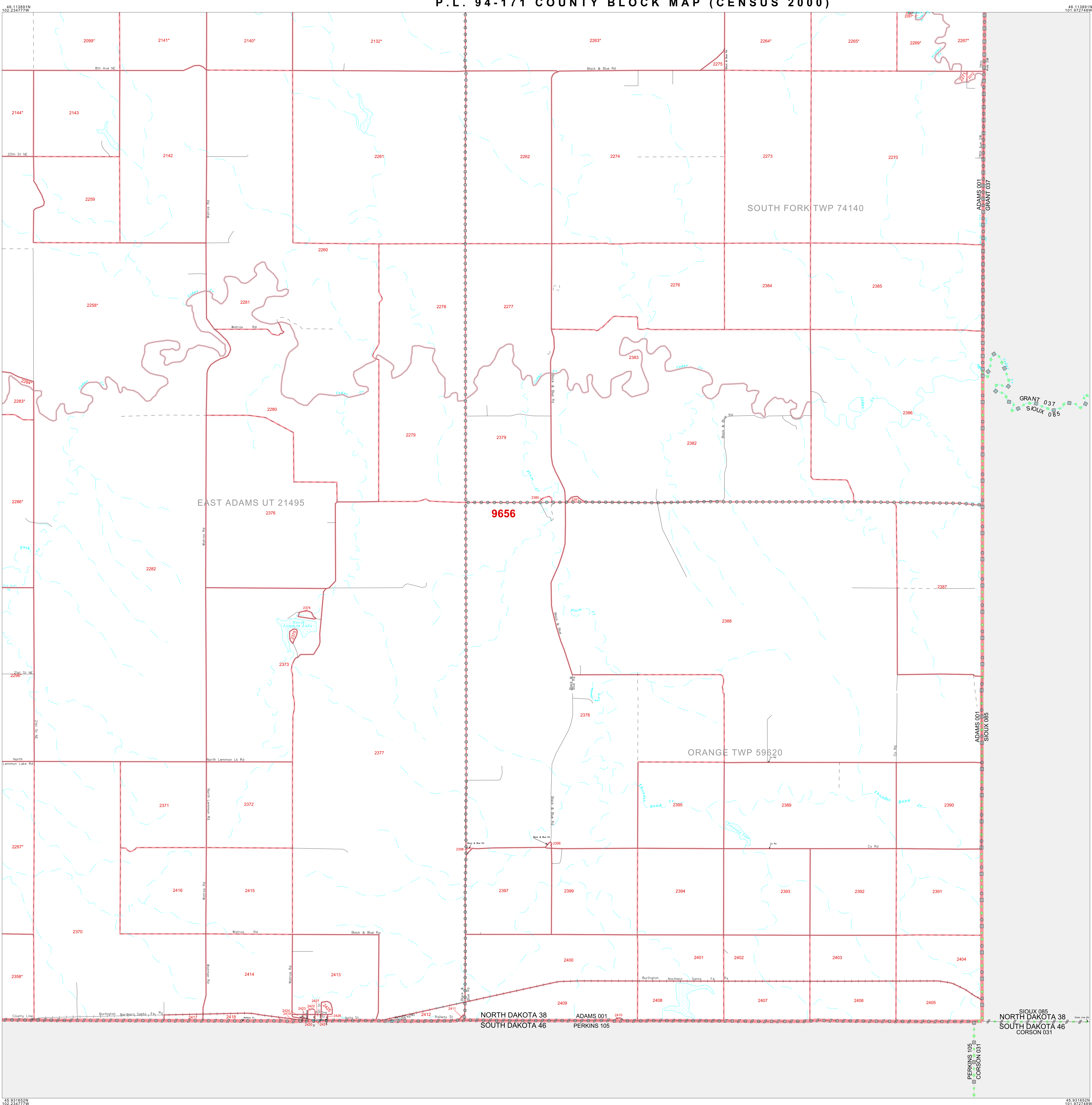

GEOGRAPHIC AREAS LEGEND

SYMBOL	NAME STYLE
*****	INTERNATIONAL
*****	AIR (FEDERAL) Trust Land
*****	TRIBAL SUBDIVISION
//////	STATE
	COUNTY
-----	MINOR CIVIL DIV ¹
-----	Incorporated Place ¹
-----	Census Designated Place ¹
-----	Corporate Offset Boundary
-----	Census Tract
-----	BLOCK ²

Military: Inset Out Area

Abbreviation Reference: AIR = American Indian Reservation; Trust Land = GTR-Reservation Trust Land; Tribal Subdivision = American Indian Tribal Subdivision
¹ A "*" following a place name indicates that the place is coterminous with a MCD. "A" indicates that the place is also a false MCD. In both cases, the MCD name is shown only where it differs from the place name.
² A "*" following a block number indicates that the block number is repeated elsewhere in the block.

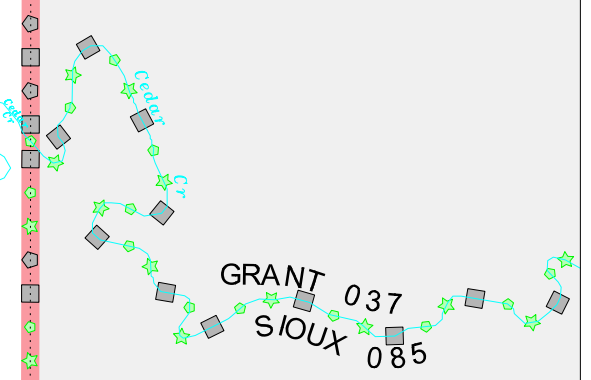

46 113891N 102 234777W
 46 931852N 102 234777W
 46 931852N 101 972748W
 46 931852N 101 972748W

NORTH DAKOTA 38
 SOUTH DAKOTA 46
 ADAMS 001
 PERKINS 105
 CORSON 031

SOUTH FORK TWP 74140
 EAST ADAMS UT 21495
 ORANGE TWP 59620

9656

1 mi
 2 km
 The plotted map scale is 1:27500

Sheet Location within County

3	4
7	8

Key to Adjacent Sheets

ST: North Dakota (38)
 COU: Adams (001)
 SHEET 8 OF 8 PARENT SHEETS

All legal boundaries and names are as of January 1, 2000.
 The boundaries shown on this map are for Census Bureau statistical data collection and tabulation purposes only; their depiction and designation for statistical purposes does not constitute a determination of jurisdictional authority or rights of ownership or entitlement.
 U.S. DEPARTMENT OF COMMERCE Economics and Statistics Administration U.S. Census Bureau

